

NOTES CONTINUED:

⑤
THREE DIGIT SERIAL NUMBER. SERIAL NUMBERS START AT 001 FOR THE FIRST ARTICLE AND PROCEED CONSECUTIVELY. USE .07" HIGH CHARACTERS. EXAMPLE: DXXXXXX-VY, S/N 001. A VIBRATORY TOOL MAY BE USED.

REV.	DATE	DCN #	DRAWING TREE #
-	-	-	-
-	-	-	-
-	-	-	-

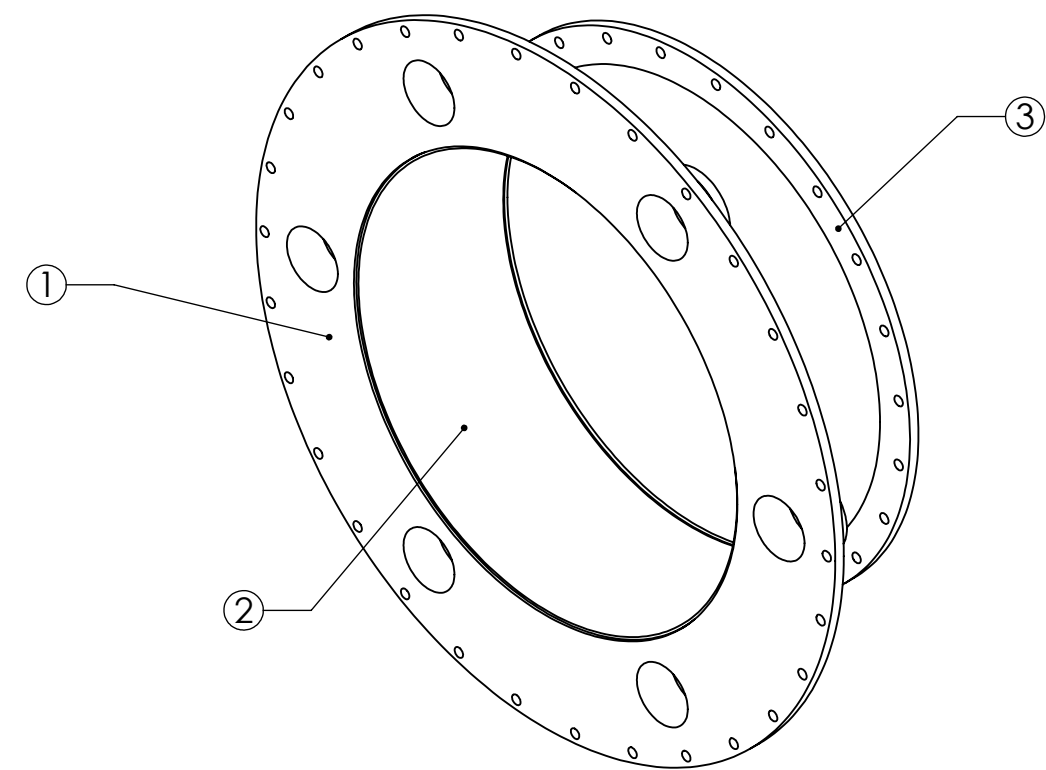
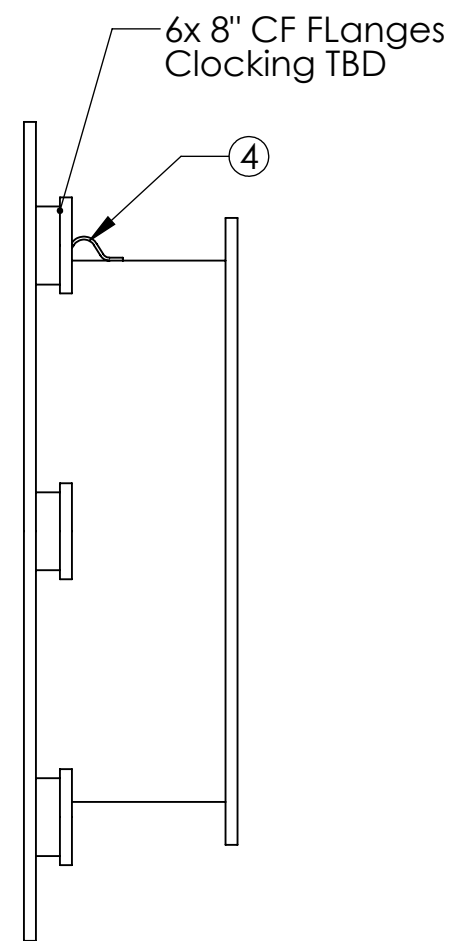
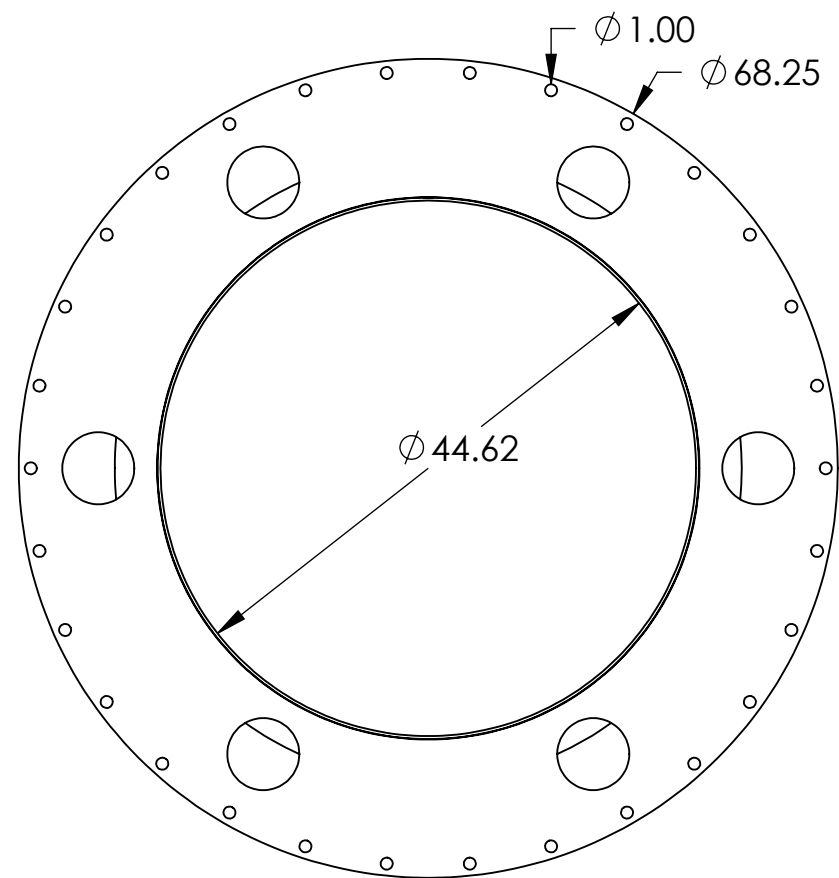
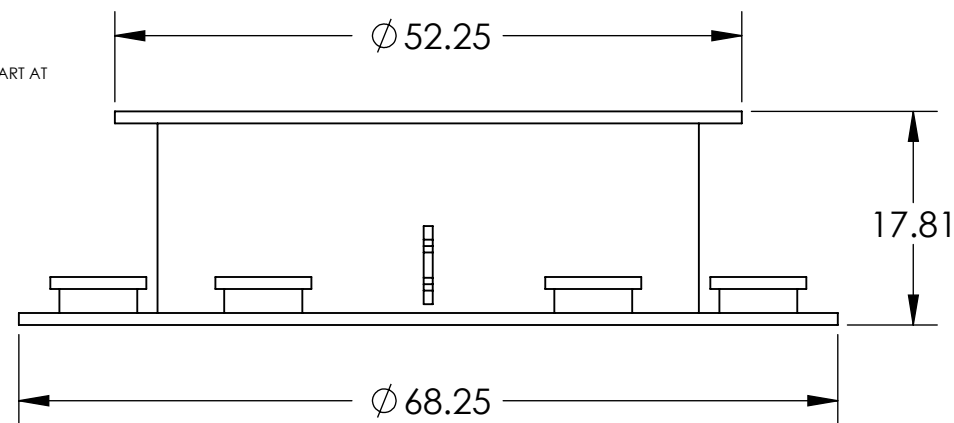

Item #	Part #	Description	Material	Req	Spare	Total
1	D0900961	Flange, Flat Faced, 45.19ID x 68.25OD D961129-01, PSI 049-4-58	AISI 304	1		1
2	D0900962	Cylindrical Shell fo Adapter A-16, 44.625ID, LGO VE	AISI 304	1		1
3	D0900963	Flat Faced Flange, 44.625ID, LIGO VE D961124-01, PSI V049-4-042	AISI 304	1		1
4	D0900964	Lifting Lug, D970446-00, PSI V049-4-159	AISI 304	1		1

NOTES AND TOLERANCES: (UNLESS OTHERWISE SPECIFIED)

1. REMOVE ALL SHARP EDGES, R.02 MIN.
2. DO NOT SCALE FROM DRAWING.
3. DESIGN AND FABRICATE THIS COMPONENT PER LIGO SPECIFICATION E0900411-V1

DIMENSIONS ARE IN
TOLERANCES:
.XX ±
.XXX ±
ANGULAR ± °

MATERIAL: N/A
FINISH: N/A μinch

LIGO CALIFORNIA INSTITUTE OF TECHNOLOGY
MASSACHUSETTS INSTITUTE OF TECHNOLOGY

SYSTEM: ADVANCED LIGO
SUB-SYSTEM: FMP
NEXT ASSY:

PART NAME: Adapter A-16, 44 1/4" I.D. x 60 1/2" I.D., LIGO VE
DESIGNER: Dennis Coyne 12 May 2009
DRAFTER:
CHECKER:
APPROVAL:

SIZE: B
DWG. NO.: D0900946
REV.: 2

SCALE: 1:16
PROJECTION: SHEET 1 OF 1

LIGO_D0900946_V2, PART PDM REV: X-005, DRAWING PDM REV: