

REV.	DATE	DCN #	DRAWING TREE #
v1	27 JUL 2009	E0900221	E080191
v2	10 AUG 2010	E1000301	E080191
v3	24 OCT 2011	E1101053	E080191
v4	12 FEB 2012	E1200212	E080191

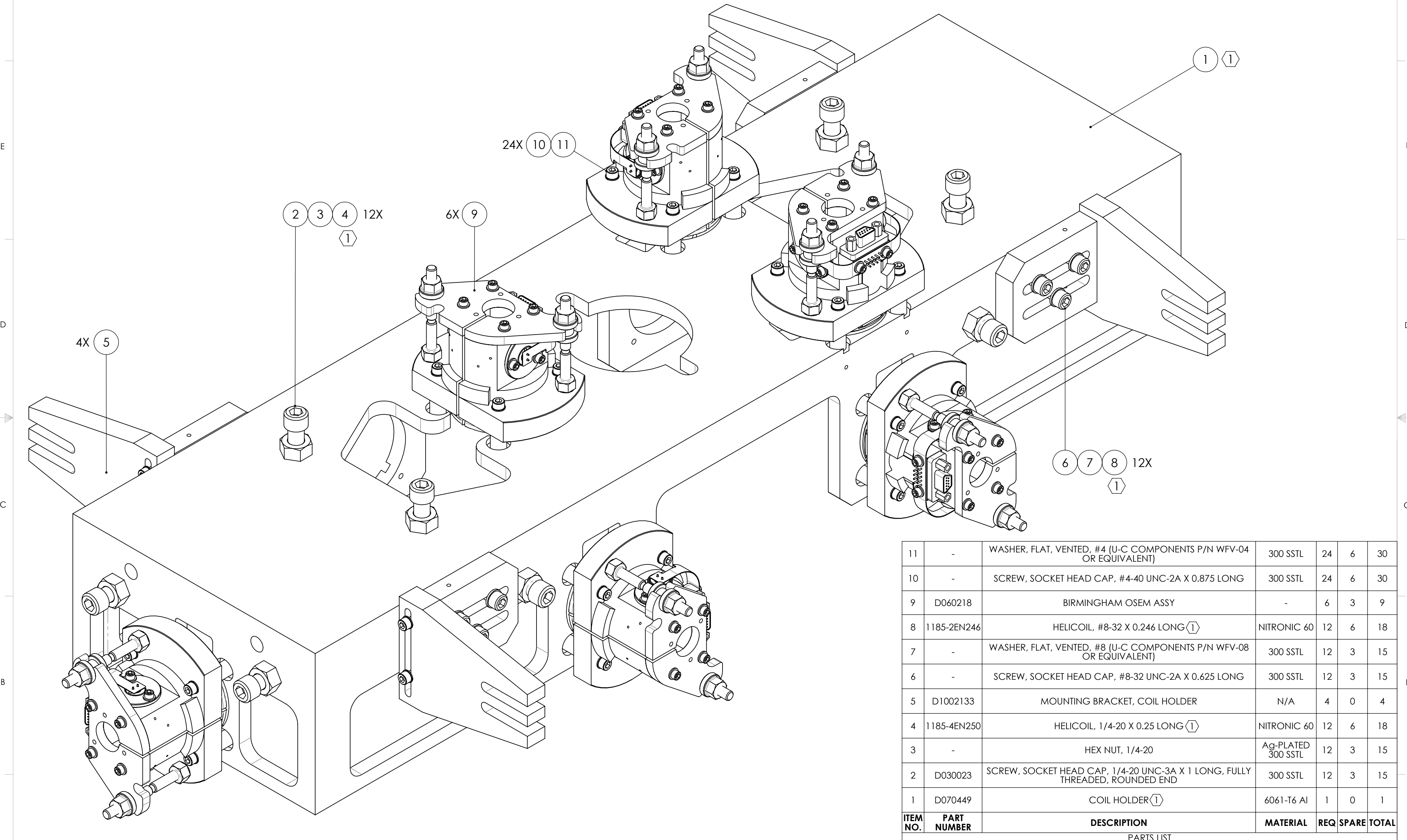

ITEM NO.	PART NUMBER	DESCRIPTION	MATERIAL	REQ	SPARE	TOTAL
11	-	WASHER, FLAT, VENTED, #4 (U-C COMPONENTS P/N WFV-04 OR EQUIVALENT)	300 SSSL	24	6	30
10	-	SCREW, SOCKET HEAD CAP, #4-40 UNC-2A X 0.875 LONG	300 SSSL	24	6	30
9	D060218	BIRMINGHAM OSEM ASSY	-	6	3	9
8	1185-2EN246	HELICOIL, #8-32 X 0.246 LONG (1)	NITRONIC 60	12	6	18
7	-	WASHER, FLAT, VENTED, #8 (U-C COMPONENTS P/N WFV-08 OR EQUIVALENT)	300 SSSL	12	3	15
6	-	SCREW, SOCKET HEAD CAP, #8-32 UNC-2A X 0.625 LONG	300 SSSL	12	3	15
5	D1002133	MOUNTING BRACKET, COIL HOLDER	N/A	4	0	4
4	1185-4EN250	HELICOIL, 1/4-20 X 0.25 LONG (1)	NITRONIC 60	12	6	18
3	-	HEX NUT, 1/4-20	Ag-PLATED 300 SSSL	12	3	15
2	D030023	SCREW, SOCKET HEAD CAP, 1/4-20 UNC-3A X 1 LONG, FULLY THREADED, ROUNDED END	300 SSSL	12	3	15
1	D070449	COIL HOLDER (1)	6061-T6 Al	1	0	1
PARTS LIST						

NOTES AND TOLERANCES: (UNLESS OTHERWISE SPECIFIED)

(1) HELICOILS TO BE INSTALLED INTO ITEM NO. 1 BY LIGO AFTER ALL PARTS ARE CLEANED AND BAKED.
 2. PARTS TO BE ASSEMBLED ACCORDING TO E080208 HLTS ASSEMBLY SPECIFICATION.

MATERIAL: N/A
 FINISH: N/A μinch

LIGO CALIFORNIA INSTITUTE OF TECHNOLOGY
 MASSACHUSETTS INSTITUTE OF TECHNOLOGY

SYSTEM: ADVANCED LIGO SUB-SYSTEM: SUS

NEXT ASSY: HLTS OVERALL ASSY

PART NAME: COIL HOLDER ASSY

DESIGNER: D. BRIDGES 21 FEB 2012 SIZE: c DWG. NO.: D080677 REV.: v4

DRAFTER: D. BRIDGES 21 FEB 2012

CHECKER: B. MOORE 21 FEB 2012

APPROVAL: _____ SCALE: 1:1 PROJECTION: SHEET 1 OF 1