

REV.	DATE	DCN #	DRAWING TREE #
v1	08 JUN 2009	E0900166	E080191
v2	10 AUG 2009	E0900239	E080191
-	-	-	-

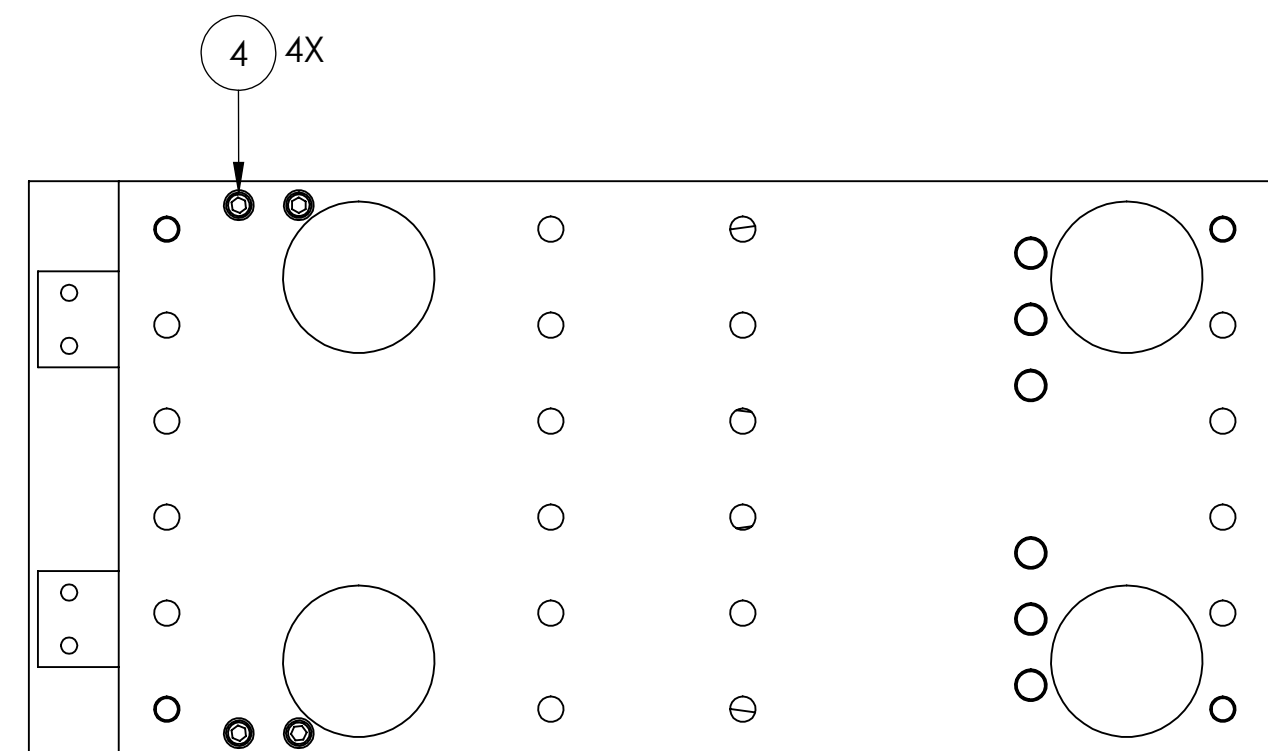
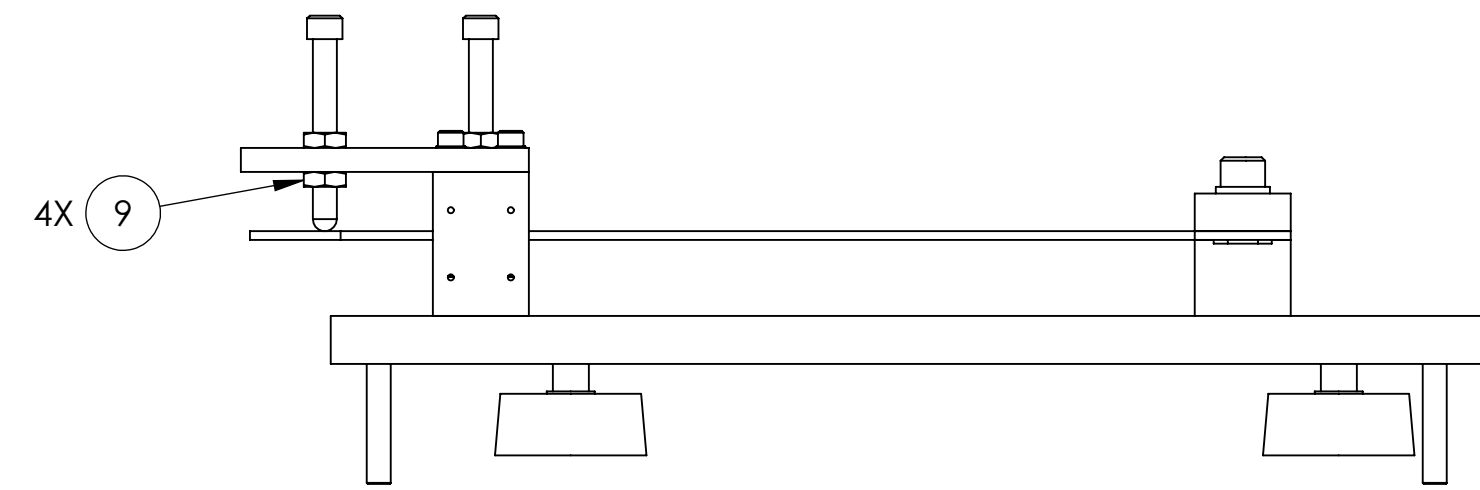
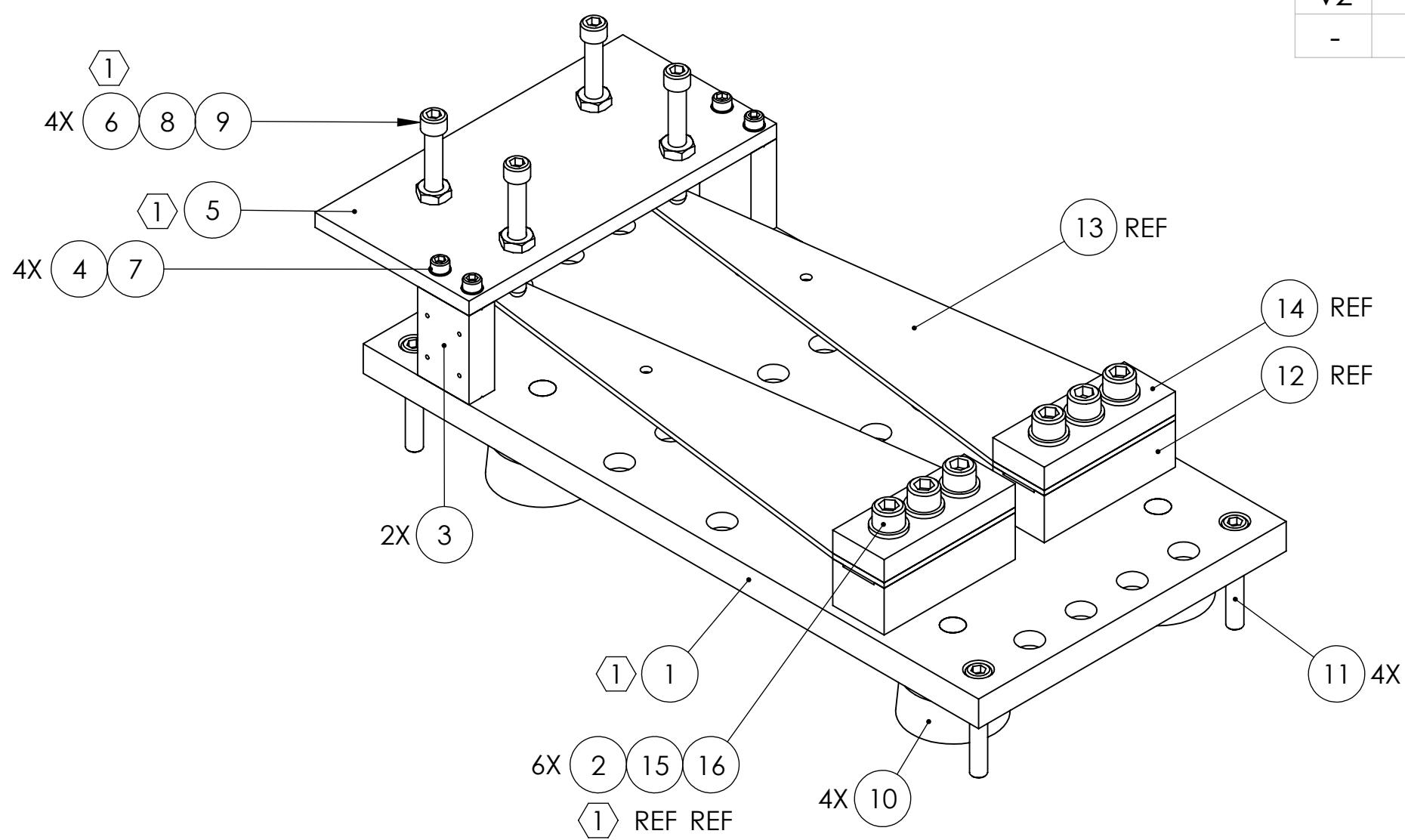

ITEM NO.	PART NUMBER	DESCRIPTION	MATERIAL	REQ	SPARE	TOTAL
16	-	SCREW, SOCKET HEAD CAP, 5/16-18 UNC-2A X 1.75 LONG	Ag-PLATED 300 SSSL	REF	0	REF
15	-	WASHER, FLAT, 5/16 (NAS 1149-C516 OR EQUIVALENT)	300 SSSL	REF	0	REF
14	D020601	BLADE CLAMP, UPPER BLADE, OUTSIDE	304, 316 OR 302 SSSL	REF	0	REF
13	D020617	UPPER BLADE, HLTS	MARAGING STEEL C250	REF	0	REF
12	D020622	BLADE CLAMP, UPPER BLADE, INSIDE	304, 316 OR 302 SSSL	REF	0	REF
11	-	SCREW, SOCKET HEAD CAP, 1/4-20 UNC-2A X 1.5 LONG	300 SSSL	4	4	8
10	83685T16	LEVELING MOUNT (MCMaster-CARR P/N)	304 SSSL	4	1	5
9	-	JAM NUT, 1/4-20	300 SSSL	8	2	10
8	D0900999	SCREW, SOCKET HEAD CAP, 1/4-20 UNC-2A X 2 LONG, FULLY THREADED, ROUNDED END	300 SSSL	4	1	5
7	-	WASHER, FLAT, #8 (NAS 620-C8L OR EQUIVALENT)	300 SSSL	4	1	5
6	1185-4EN250	HELICOIL, 1/4-20 X 0.25 LONG (1)	NITRONIC 60	4	2	6
5	D080267	TOP BRIDGE (1)	304, 316 OR 302 SSSL	1	0	1
4	-	SCREW, SOCKET HEAD CAP, #8-32 UNC-2A X 0.75 LONG	Ag-PLATED 300 SSSL	8	2	10
3	D070558	SIDE SUPPORT	304, 316 OR 302 SSSL	2	0	2
2	1185-5EN469	HELICOIL, 5/16-18 X 0.469 LONG (1)	NITRONIC 60	6	4	10
1	D080268	BASE PLATE (1)	304, 316 OR 302 SSSL	1	0	1
PARTS LIST						

NOTES AND TOLERANCES: (UNLESS OTHERWISE SPECIFIED)

(1) HELICOILS TO BE INSTALLED INTO ITEM NO. 1 AND ITEM NO. 5 BY LIGO PRIOR TO ASSEMBLY AND AFTER ALL PARTS ARE CLEANED AND BAKED.

MATERIAL: N/A

FINISH: N/A μinch

**LIGO** CALIFORNIA INSTITUTE OF TECHNOLOGY  
MASSACHUSETTS INSTITUTE OF TECHNOLOGY

SYSTEM: ADVANCED LIGO SUB-SYSTEM: SUS

NEXT ASSY: HLTS OVERALL ASSY AND FIXTURES

PART NAME: UPPER BLADE BAKE FIXTURE

DESIGNER: G. SCARBOROUGH 02 JUN 2008 SIZE: C DWG. NO.: D080265 REV.: v2

DRAFTER: D. BRIDGES 12 AUG 2009

CHECKER: M. MEYER 13 AUG 2009

APPROVAL: [Signature]

SCALE: 1:2 PROJECTION: [Symbol] SHEET 1 OF 1