

D080181_Advanced_LIGO_SUS_HLTs_Intermediate_Mass_Changer_Assembly, PART PDM REV: X-014, DRAWING PDM REV: X-006

REV.	DATE	DCN #	DRAWING TREE #
v1	24 JUN 2009	E0900176	E080191
-	-	-	-
-	-	-	-

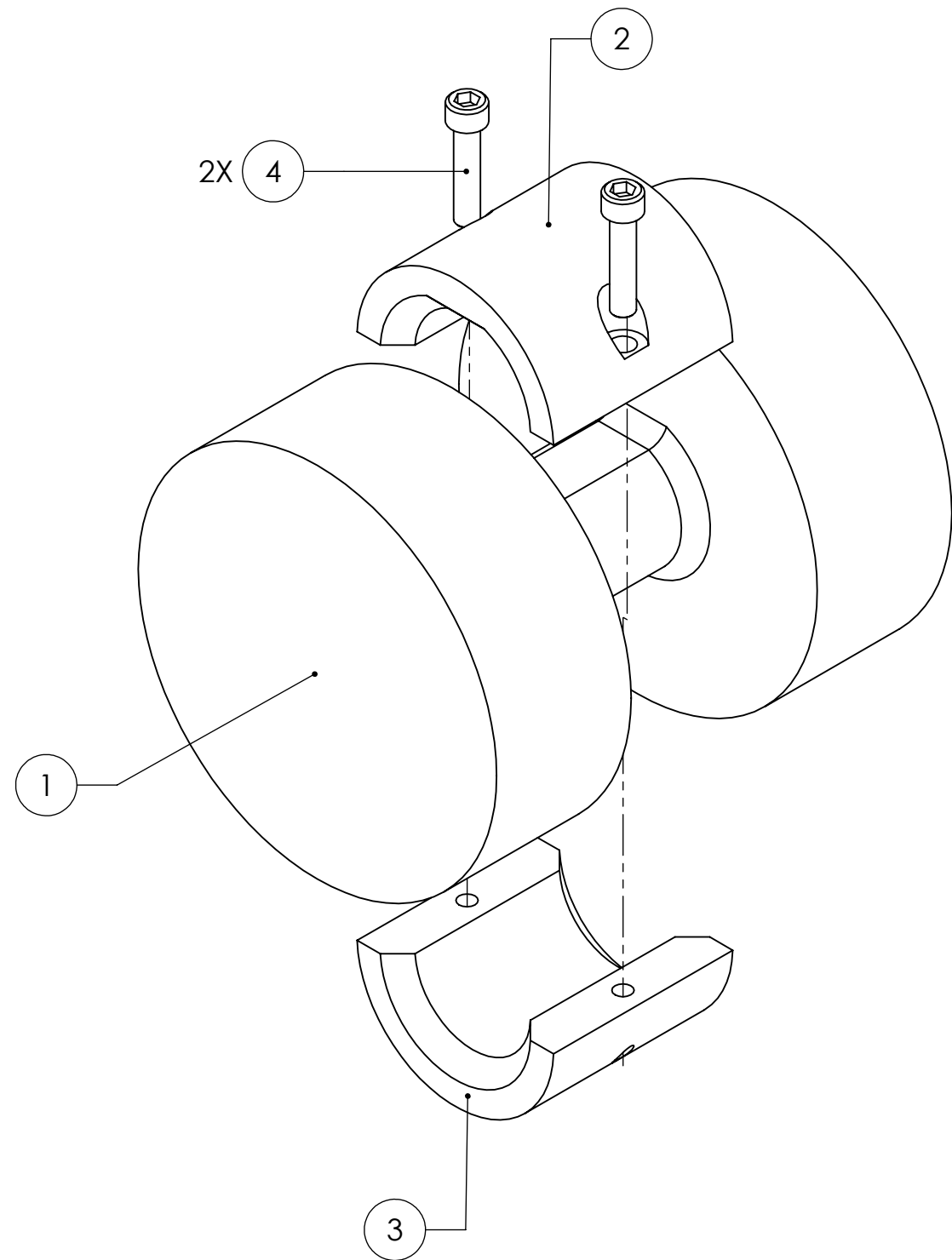

ITEM NO.	PART NUMBER	DESCRIPTION	MATERIAL	REQ	SPARE	TOTAL
4	-	SCREW, SOCKET HEAD CAP, #8-32 UNC-2A X 0.75 LONG	Ag-PLATED 300 SSTL	2	1	3
ALT	D080238	COLLAR, LOWER, 900g	304 SSTL	-	0	0
ALT	D080236	COLLAR, LOWER, 700g	304 SSTL	-	0	0
ALT	D080234	COLLAR, LOWER, 500g	304 SSTL	-	0	0
ALT	D080232	COLLAR, LOWER, 300g	6061-T6 Al	-	0	0
3	D080183	COLLAR, LOWER, 100g	6061-T6 Al	1	0	1
ALT	D080229	COLLAR, UPPER, 900g	304 SSTL	-	0	0
ALT	D080227	COLLAR, UPPER, 700g	304 SSTL	-	0	0
ALT	D080225	COLLAR, UPPER, 500g	304 SSTL	-	0	0
ALT	D080223	COLLAR, UPPER, 300g	6061-T6 Al	-	0	0
2	D080182	COLLAR, UPPER, 100g	6061-T6 Al	1	0	1
1	D030155	CENTER OFFSET	6061-T6 Al	1	0	1

PARTS LIST

NOTES AND TOLERANCES: (UNLESS OTHERWISE SPECIFIED)

1. PARTS TO BE ASSEMBLED ACCORDING TO E080208 HLTs ASSEMBLY SPECIFICATION.

MATERIAL N/A

FINISH N/A μinch

LIGO CALIFORNIA INSTITUTE OF TECHNOLOGY
MASSACHUSETTS INSTITUTE OF TECHNOLOGY

SYSTEM: **ADVANCED LIGO** SUB-SYSTEM: **SUS**

NEXT ASSY: **INTERMEDIATE MASS ASSY**

PART NAME: **INT. MASS CHANGER ASSY**

DESIGNER	D. BRIDGES	28 AUG 2009	SIZE	DWG. NO.	REV.
DRAFTER	D. BRIDGES	24 JUN 2009	B	D080181	v1
CHECKER	M. MEYER	24 JUN 2009			
APPROVAL					

SCALE: 1:1 PROJECTION: SHEET 1 OF 1