

REV.	DATE	DCN #	DRAWING TREE #
A	28 MAR 2008	E080113-00	
v1	15 MAY 2009	E0900149	

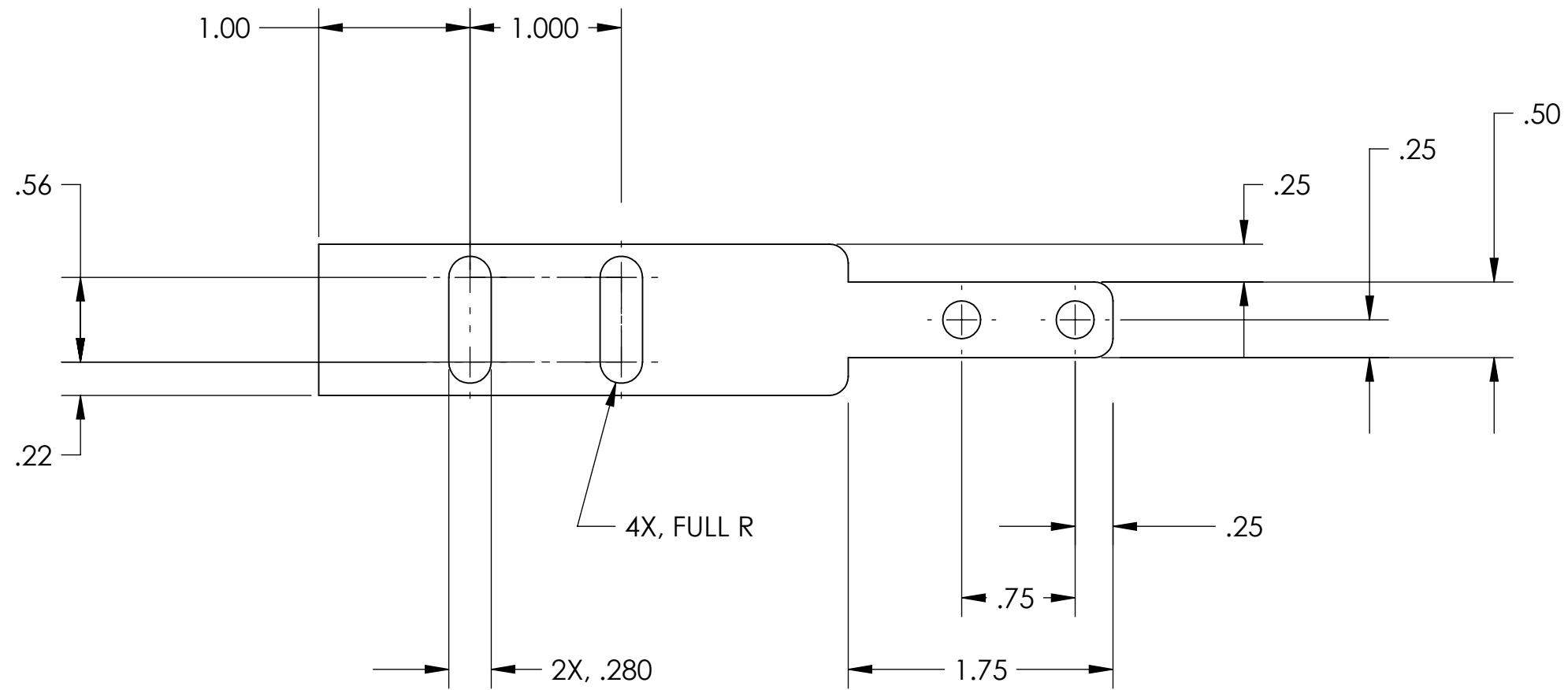
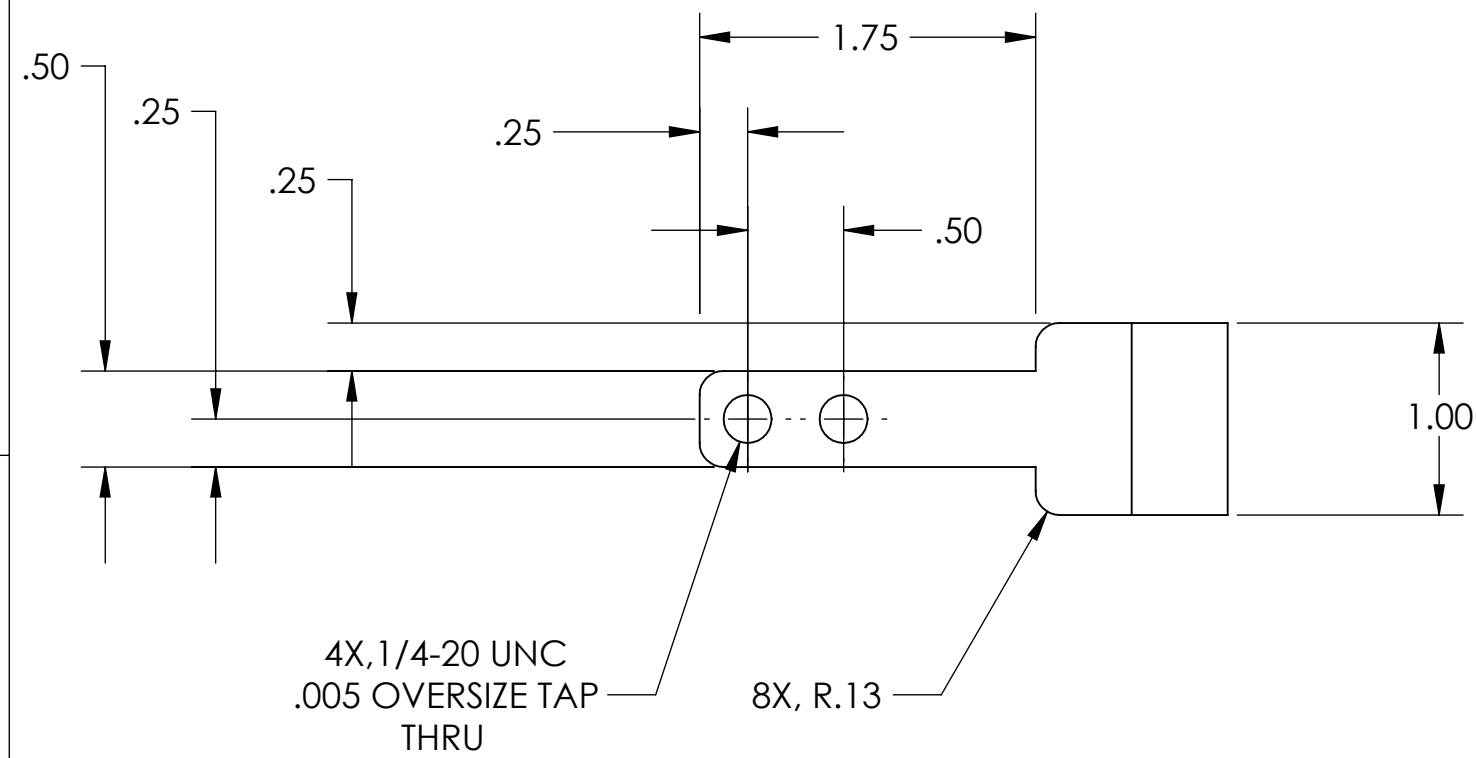
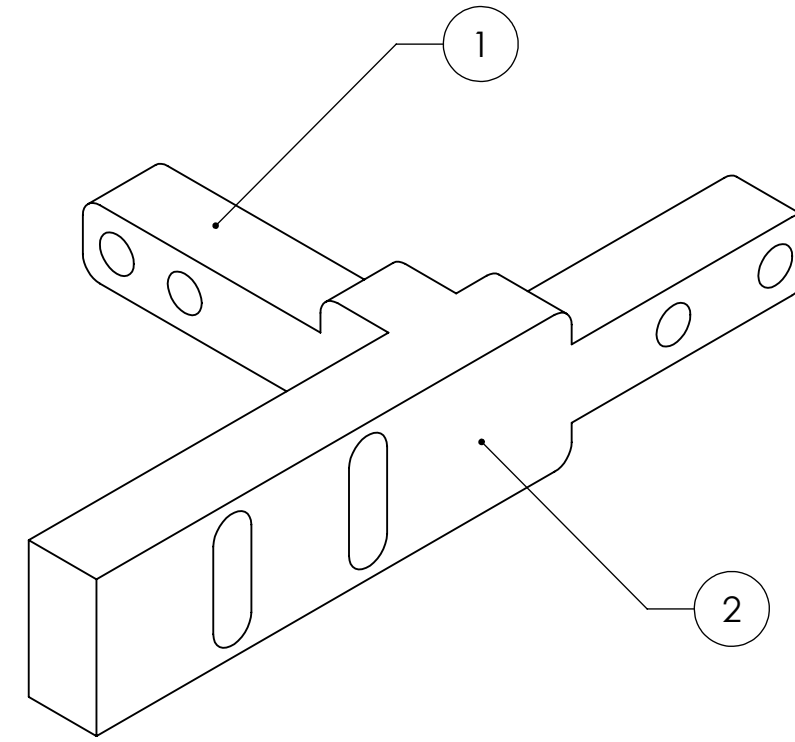
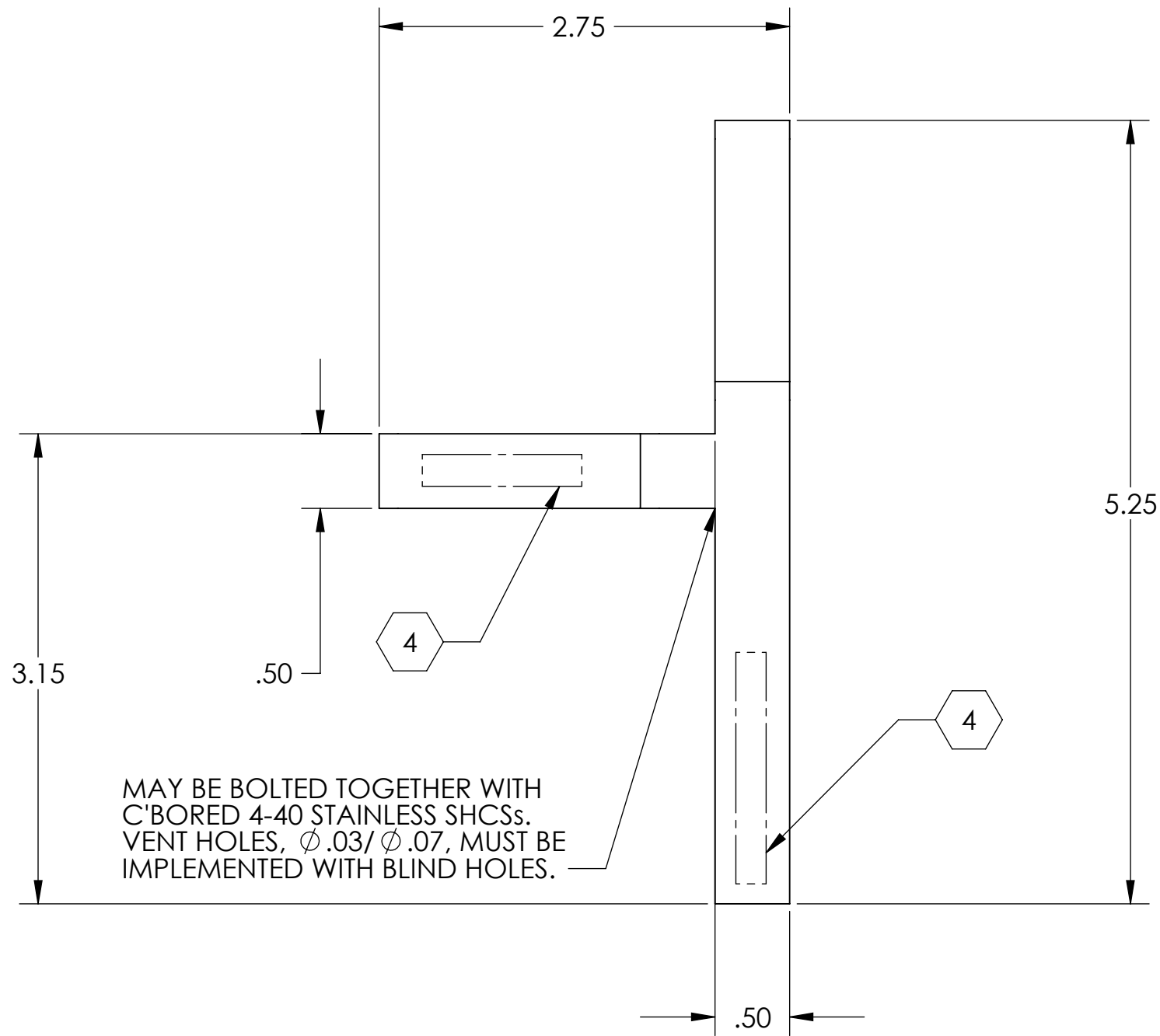

ITEM NUMBER	QTY	DASH NUMBER
2	1	-02
1	1	-01

PARTS LIST		
NOTES: (UNLESS OTHERWISE SPECIFIED)		
1. DO NOT SCALE FROM DRAWING. 2. REMOVE ALL SHARP EDGES. R.02 MIN. 3. ALL MACHINING FLUIDS SHALL BE WATER SOLUBLE AND FREE OF SULFUR, CHLORINE AND SILICONE, SUCH AS CINCINNATI MILACRON'S CIMTECH 410 (STAINLESS STEEL). @ SCRIBE, ENGRAVE, OR MECHANICALLY STAMP (NO INKS OR DYES) DRAWING PART NUMBER, DASH NUMBER, AND REVISION ON NOTED SURFACES FOLLOWED ON THE NEXT LINE BY A THREE DIGIT SERIAL NUMBER. SERIAL NUMBERS START AT 001 FOR THE FIRST ARTICLE AND PROCEED CONSECUTIVELY. USE .07" HIGH CHARACTERS. EXAMPLE: DXXXXX-0X-vY, S/N 001. A VIBRATORY TOOL MAY BE USED.		
DIMENSIONS ARE IN INCHES		
TOLERANCES: .XX ± .01 .XXX ± .005 ANGULAR ± .5°		
MATERIAL	6061-T6 Al	SYSTEM ADVANCED LIGO
FINISH	32 μ inch	SUB-SYSTEM SUS
DRAWN J. ROMIE 12 NOV 2007		NEXT ASSY D060306
CHECKED D. BRIDGES 26 MAR 2008	SIZE C	PART NAME EQ BRACKET SIDE ALT
APPROVED	DWG. NO. D070484	REV. v1
SCALE: 1:1 PROJECTION:  SHEET 1 OF 1		