

REV.	DATE	DCN #	DRAWING TREE #
v1	24 JUN 2009	E0900176	E080191
v2	02 DEC 2009	E0900446	E080191
-	-	-	-

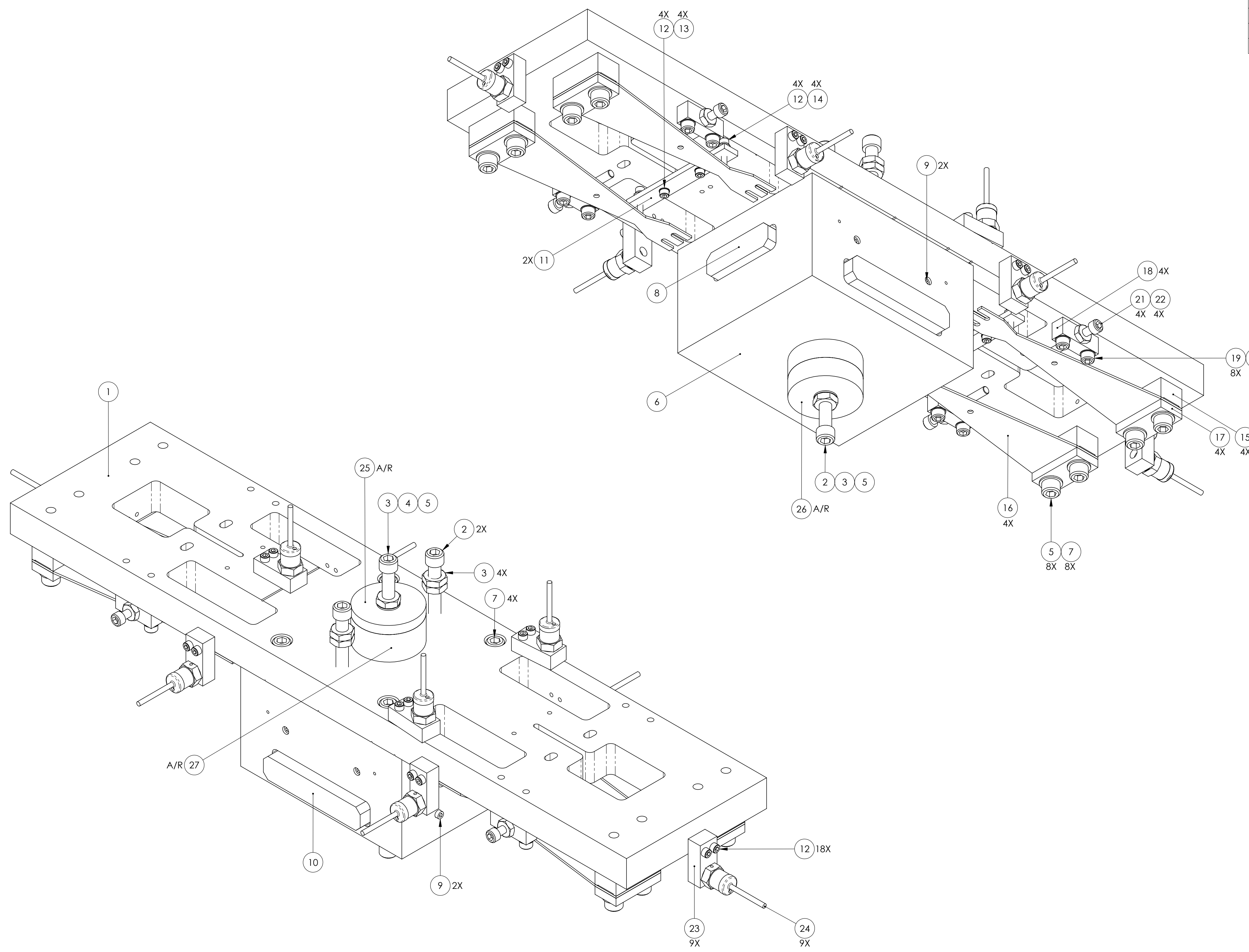

ITEM NO.	PART NUMBER	DESCRIPTION	MATERIAL	REQ	SPARE	TOTAL
27	D080263	ADDITIONAL MASS DISK, 150g	304, 316 OR 302 SSSL	A/R	0	0
26	D070333	ADDITIONAL MASS DISK, 100g	304, 316 OR 302 SSSL	A/R	0	0
25	D0901405	ADDITIONAL MASS DISK, 50g	304, 316 OR 302 SSSL	A/R	0	0
24	D060416	MAGNET AND FLAG ASSY	N/A	9	1	10
23	D070020	MAGNET HOLDER	6061-T6 Al	9	1	10
22	-	HEX NUT, #8-32	300 SSSL	4	1	5
21	-	SCREW, SOCKET HEAD CAP, #8-32 UNC-2A X 1.5 LONG, FULLY THREADED	300 SSSL	4	1	5
20	-	WASHER, FLAT, #8 (NAS 620-C8L OR EQUIVALENT)	300 SSSL	8	2	10
19	-	SCREW, SOCKET HEAD CAP, #8-32 UNC-2A X 1 LONG	Ag-PLATED 300 SSSL	8	2	10
18	D020653	SCREWDRIVE SYSTEM	6061-T6 Al	4	0	4
17	D020623	BLADE CLAMP, LOWER BLADE, OUTSIDE	304, 316 OR 302 SSSL	4	0	4
16	D020615	HLTS LOWER BLADE	MARAGING STEEL C250	4	0	4
15	D020602	BLADE CLAMP, LOWER BLADE, INSIDE	304, 316 OR 302 SSSL	4	0	4
14	-	HEX NUT, #4-40	300 SSSL	4	1	5
13	-	WASHER, FLAT, #4 (NAS 620-C4L OR EQUIVALENT)	300 SSSL	4	1	5
12	-	SCREW, SOCKET HEAD CAP, #4-40 UNC-2A X 0.625 LONG	Ag-PLATED 300 SSSL	26	6	32
11	D080221	GUARD, LOWER BLADE	304, 316 OR 302 SSSL	2	0	2
10	D020608	X-DIRECTION OFFSET, T-PIECE	304, 316 OR 302 SSSL	1	0	1
9	-	SCREW, SOCKET SET, #8-32 UNC-2A X 1 LONG	Ag-PLATED 300 SSSL	4	1	5
8	D030139	Y-DIRECTION OFFSET, T-PIECE	304, 316 OR 302 SSSL	1	0	1
7	-	SCREW, SOCKET HEAD CAP, 1/4-20 UNC-2A X 1.25 LONG	Ag-PLATED 300 SSSL	12	3	15
6	D020607	T-PIECE, UPPER MASS	304, 316 OR 302 SSSL	1	0	1
5	-	WASHER, FLAT, 1/4 (NAS 620-C416L OR EQUIVALENT)	300 SSSL	10	2	12
4	-	SCREW, SOCKET HEAD CAP, 1/4-20 UNC-2A X 2.5 LONG	Ag-PLATED 300 SSSL	1	1	2
3	-	JAM NUT, 1/4-20	300 SSSL	6	2	8
2	-	SCREW, SOCKET HEAD CAP, 1/4-20 UNC-2A X 2 LONG	Ag-PLATED 300 SSSL	3	1	4
1	D020605	MAIN SECTION	304, 316 OR 302 SSSL	1	0	1

NOTES AND TOLERANCES: (UNLESS OTHERWISE SPECIFIED)
 1. PARTS TO BE ASSEMBLED ACCORDING TO E080208 HLTS ASSEMBLY SPECIFICATION.

MATERIAL: N/A
 FINISH: N/A μinch

LIQO CALIFORNIA INSTITUTE OF TECHNOLOGY
 MASSACHUSETTS INSTITUTE OF TECHNOLOGY

SYSTEM: ADVANCED LIQO
 SUB-SYSTEM: SUS
 NEXT ASSY: HLTS SUSPENSION ASSY

PART NAME: UPPER MASS ASSY

DESIGNER	D. BRIDGES	19 JAN 2010	SIZE	DWG. NO.	REV.
DRAFTER	D. BRIDGES	19 JAN 2010	D	D070335	v2
CHECKER	M. MEYER	20 JAN 2010	SCALE: 1:1	PROJECTION:	SHEET 1 OF 1
APPROVAL					

D070335_Advanced LIQO_SUS_HLTS_Upper_Mass_Assembly_PART PDM REV: V1-003_DRAWING PDM REV: V1-000