

REV.	DATE	DCN #	DRAWING TREE #
v1	24 JUN 2009	E0900176	E080191
v2	03 SEP 2009	E0900277	E080191
-	-	-	-

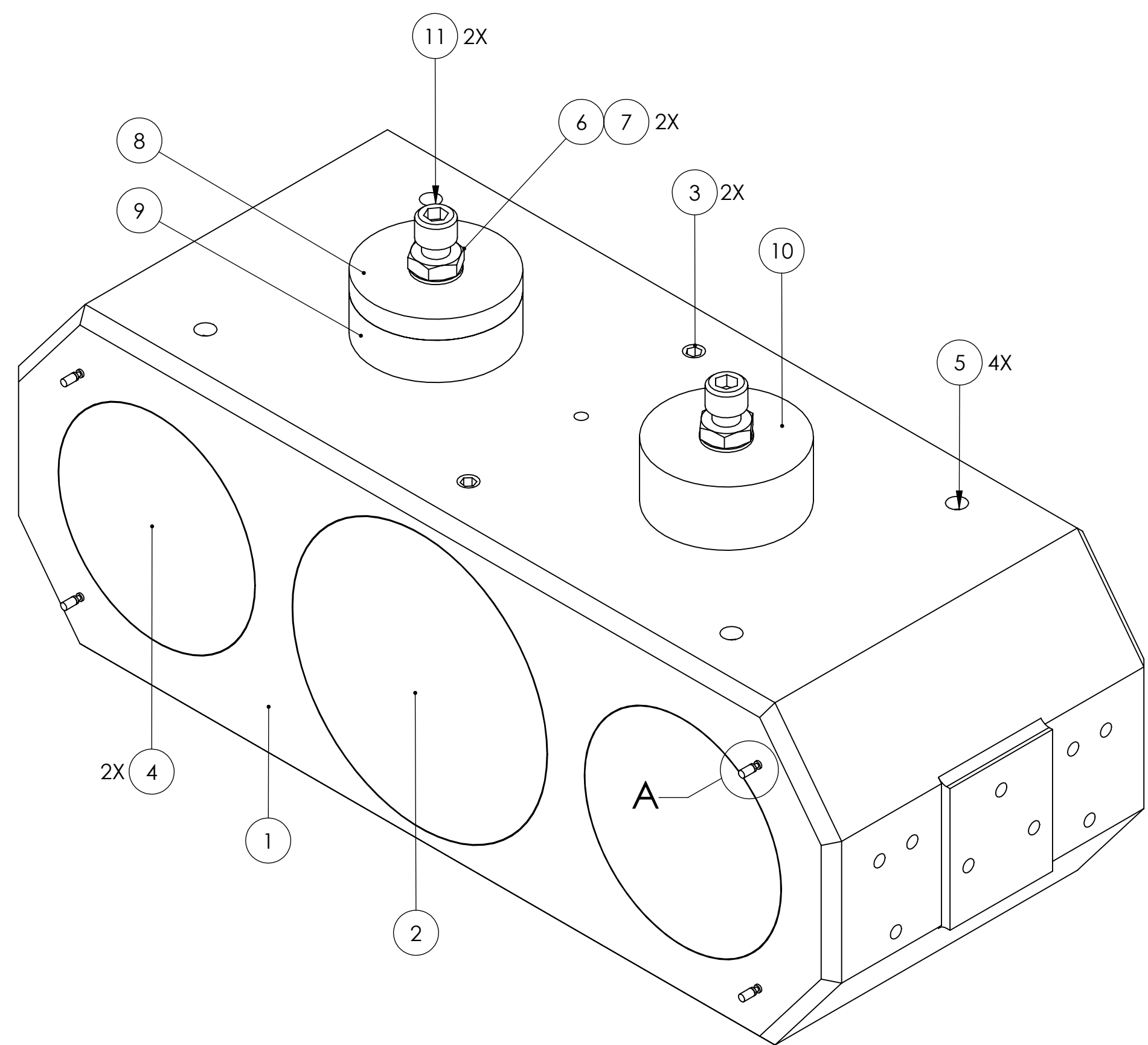

ITEM NO.	PART NUMBER	DESCRIPTION	MATERIAL	REQ	SPARE	TOTAL
14	-	UHV-COMPATIBLE ADHESIVE (CERAMABOND #835M OR EQUIVALENT)	-	A/R	0	0
13	D0901927	SINTERED SmCo MAGNET, $\phi 0.075 \times 0.125$ LONG	SmCo 2:17	4	1	5
12	D970075	DUMBBELL STANDOFF	6061-T6 Al	4	2	6
11	-	SCREW, SOCKET HEAD CAP, 1/4-20 UNC-2A X 1.5 LONG, VENTED	Ag-PLATED 300 SSSL	2	1	3
10	D080263	ADDITIONAL MASS DISK, 150g	304, 316 OR 302 SSSL	A/R	0	0
9	D070333	ADDITIONAL MASS DISK, 100g	304, 316 OR 302 SSSL	A/R	0	0
8	D0901405	ADDITIONAL MASS DISK, 50g	304, 316 OR 302 SSSL	A/R	0	0
7	-	JAM NUT, 1/4-20	300 SSSL	2	1	3
6	-	WASHER, FLAT, 1/4 (NAS 620-C416L OR EQUIVALENT)	300 SSSL	2	1	3
5	-	SCREW, SOCKET SET, 1/4-20 UNC-2A X 0.5 LONG	Ag-PLATED 300 SSSL	4	1	5
4	D030156	SIDE OFFSET	6061-T6 Al	2	0	2
3	-	SCREW, SOCKET SET, 1/4-20 UNC-2A X 0.25 LONG	Ag-PLATED 300 SSSL	2	1	3
2	D080181	INT. MASS CHANGER ASSY	N/A	1	0	1
1	D070336	MAIN SECTION	304, 316 OR 302 SSSL	1	0	1
PARTS LIST						

NOTES AND TOLERANCES: (UNLESS OTHERWISE SPECIFIED)		CALIFORNIA INSTITUTE OF TECHNOLOGY MASSACHUSETTS INSTITUTE OF TECHNOLOGY		PART NAME INTERMEDIATE MASS ASSY								
1. PARTS TO BE ASSEMBLED ACCORDING TO E080208 HLTS ASSEMBLY SPECIFICATION, USING D0901461 HLTS INTERMEDIATE MASS MAGNET PLACEMENT FIXTURE.		SYSTEM ADVANCED LIGO		SUB-SYSTEM SUS		DESIGNER D. BRIDGES	DATE 19 JUL 2009	SIZE C	DWG. NO. D070334		REV. v2	
		MATERIAL N/A		FINISH N/A $\mu$ inch		NEXT ASSY HLTS SUSPENSION ASSY		CHECKER M. MEYER		DATE 08 SEP 2009		SCALE: 1:1