

4

3

2

1

NOTES CONTINUED:

- 5. SCRIBE, ENGRAVE, OR MECHANICALLY STAMP (NO DYES OR INKS) A UNIQUE THREE DIGIT SERIAL NUMBER & REVISION NUMBER ON EACH PART. SERIAL NUMBERS START AT 001 FOR THE FIRST ARTICLE AND PROCEED CONSECUTIVELY. BAG AND TAG PARTS WITH THEIR DRAWING PART NUMBER, REVISION, VARIANT OR "TYPE" (IF APPLICABLE), AND QUANTITY, IF PARTS ARE TOO SMALL TO SCRIBE, BAGGING AND TAGGING ALONE IS SUFFICIENT.
EXAMPLE (PART): 001-v1
EXAMPLE (TAG): DXXXXXX-VY, TYPE-XX, QTY: TBD
- 6. PART IS TO BE MADE FROM STOCK SOCKET HEAD CAP SCREW, 1/4-20 UNC-3A, FULLY THREADED.
- 7. ALL PARTS SHALL BE MANUFACTURED IN ACCORDANCE WITH LIGO SPECIFICATION E0900364.

REV.	DATE	DCN #	DRAWING TREE #
A	JUL 2004	E040303	-
B	30 MAY 2008	E080195	-
v1	8 MAY 2009	E0900129	-
v2	28 JUN 2010	E1000236	-

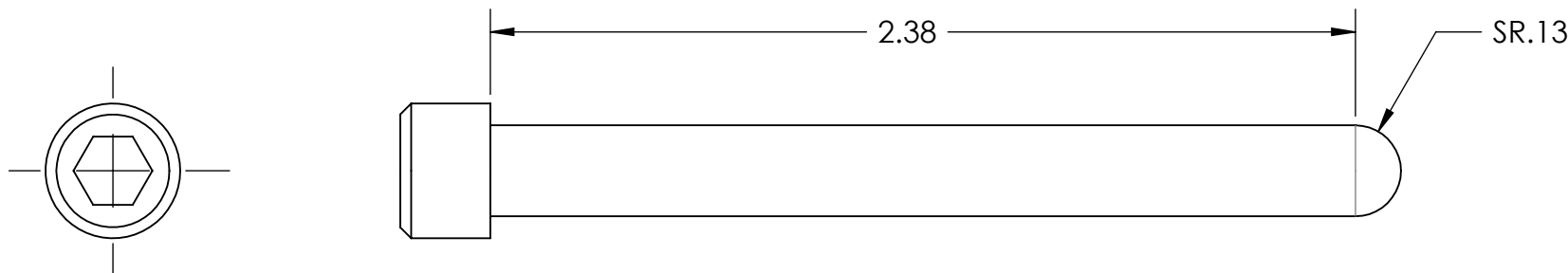

NOTES AND TOLERANCES: (UNLESS OTHERWISE SPECIFIED)

DIMENSIONS ARE IN INCHES

TOLERANCES:
.XX ± .01
.XXX ± .005

ANGULAR ± 0.1°

1. INTERPRET DRAWING PER ASME Y14.5-1994.
2. REMOVE ALL SHARP EDGES, R.02 MIN.
3. DO NOT SCALE FROM DRAWING.
4. ALL MACHINING FLUIDS MUST BE FULLY SYNTHETIC, FULLY WATER SOLUBLE AND FREE OF SULFUR, SILICONE, AND CHLORINE.

MATERIAL 300 SSSL (6)

FINISH N/A μinch

LIGO CALIFORNIA INSTITUTE OF TECHNOLOGY
MASSACHUSETTS INSTITUTE OF TECHNOLOGY

SYSTEM ADVANCED LIGO SUB-SYSTEM
NEXT ASSY MULTIPLE ASSYS

PART NAME SCREW, SOCKET HEAD CAP,
1/4-20 UNC-3A X 2.5 LONG, FULLY THREADED, ROUNDED END

DESIGNER		
DRAFTER	D. BRIDGES	24 AUG 2010
CHECKER	B. MOORE	25 AUG 2010
APPROVAL		

SIZE DWG. NO. A D030021

REV. v2

SCALE: 2:1 PROJECTION: SHEET 1 OF 1