

D0900628\_Advanced\_LIGO\_SUS\_HLTS\_Mounting\_Pad\_Side\_Bracket, PART PDM REV: X-004, DRAWING PDM REV: X-009

REV.	DATE	DCN #	DRAWING TREE #
v1	3 MAR 2009	E0900066	E080191

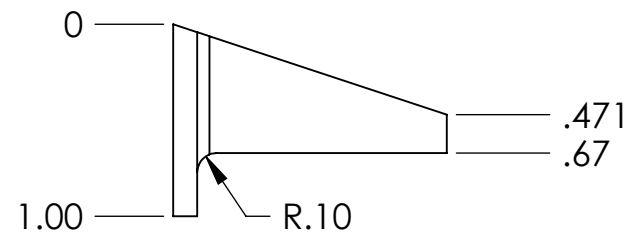
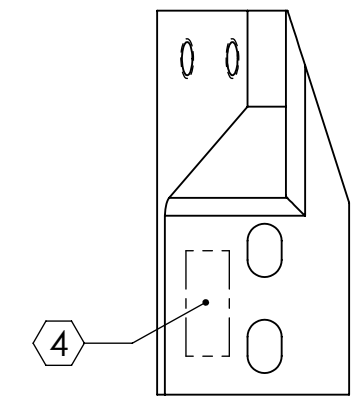
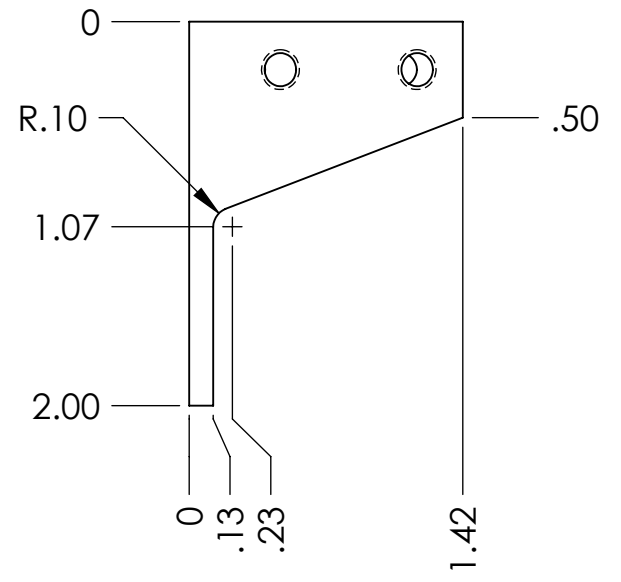
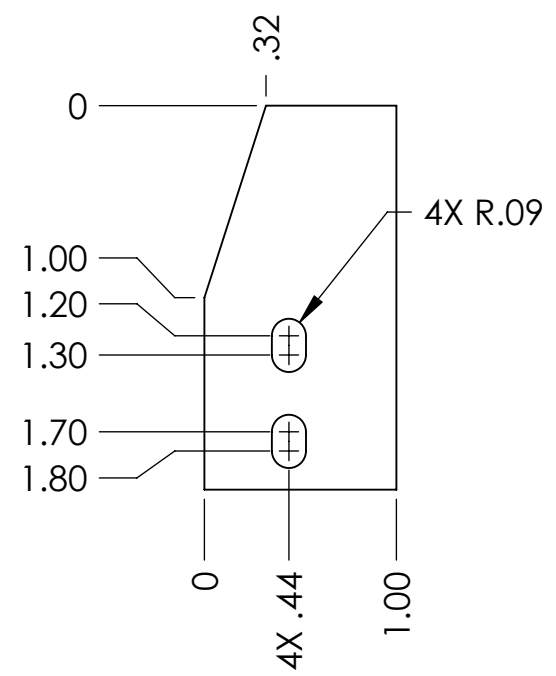
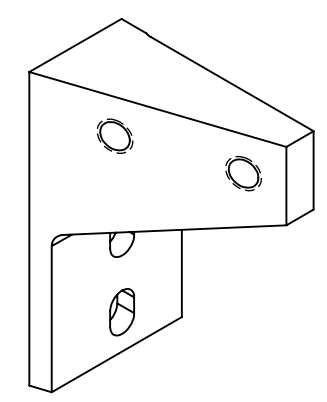
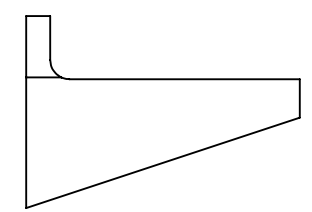
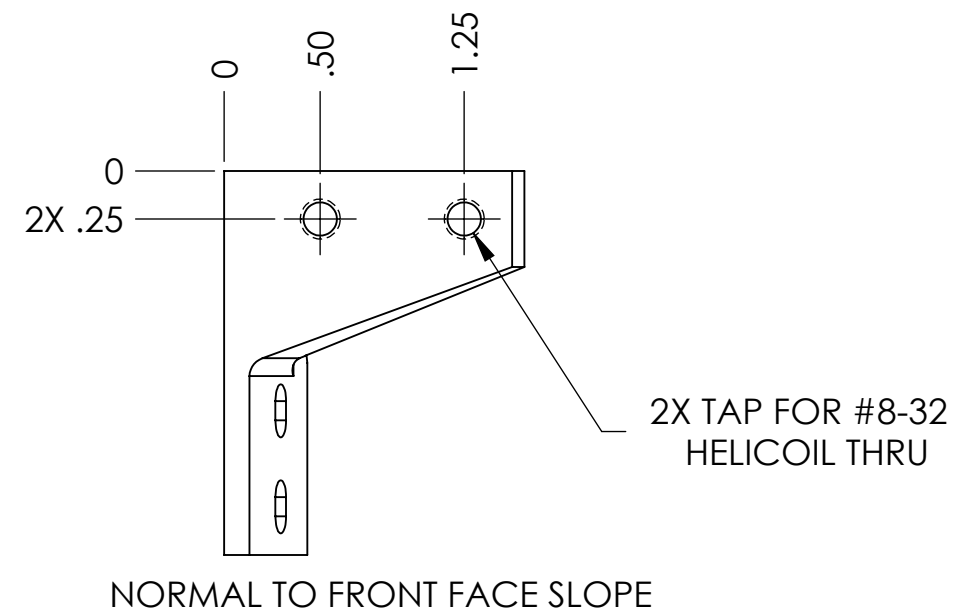

NOTES: (UNLESS OTHERWISE SPECIFIED)

- REMOVE ALL SHARP EDGES, R.02 MIN.
- DO NOT SCALE FROM DRAWING.
- ALL MACHINING FLUIDS SHALL BE WATER SOLUBLE AND FREE OF SULFUR, CHLORINE AND SILICONE, SUCH AS CINCINNATI MILACRON'S CIMTECH 410 (SSTL)
- SCRIBE, ENGRAVE, OR MECHANICALLY STAMP (NO INKS OR DYES) DRAWING PART NUMBER AND REVISION ON NOTED SURFACE FOLLOWED ON THE NEXT LINE BY A THREE DIGIT SERIAL NUMBER. SERIAL NUMBERS START AT 001 FOR THE FIRST ARTICLE AND PROCEED CONSECUTIVELY. USE .07" HIGH CHARACTERS. EXAMPLE: DXXXXXX-VY, S/N 001. A VIBRATORY TOOL MAY BE USED.

DIMENSIONS ARE IN INCHES

TOLERANCES:  
 .XX ± .01  
 .XXX ± .005

ANGULAR ± 0.5°

MATERIAL: 6061-T6 Al

FINISH: 32 μinch

DESIGNER	D. BRIDGES	9 APR 2009
DRAWN	B. MOORE	16 APR 2009
CHECKED	D. BRIDGES	22 MAY 2009

SYSTEM	ADVANCED LIGO
SUB-SYSTEM	SUS
NEXT ASSY	MOUNTING PAD ASSY
PART NAME	SIDE BRACKET, MOUNTING PAD

SIZE	DWG. NO.	REV.
B	D0900628	v1

SCALE: 1:1 PROJECTION: SHEET 1 OF 1

8 7 6 5 4 3 2 1

D  
C  
B  
A

D  
C  
B  
A

8 7 6 5 4 3 2 1