

REV.	DATE	DCN #	DRAWING TREE #
v1	3 MAR 2009	E0900066	E080191
-	-	-	-
-	-	-	-

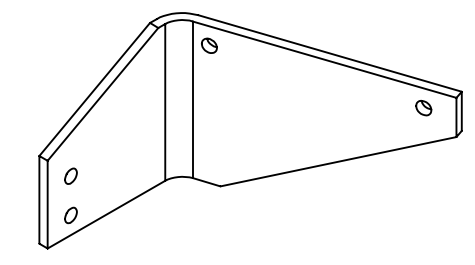

ISOMETRIC VIEW

NORMAL TO FRONT VIEW SLOPE

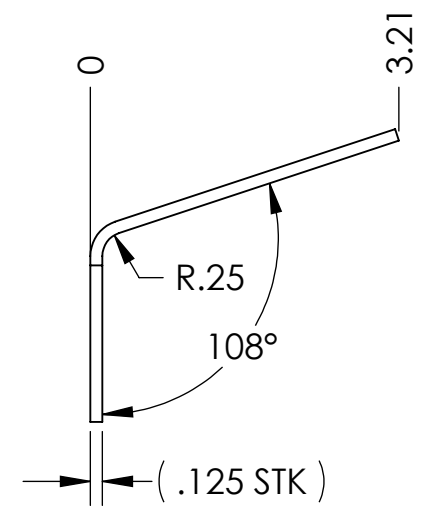
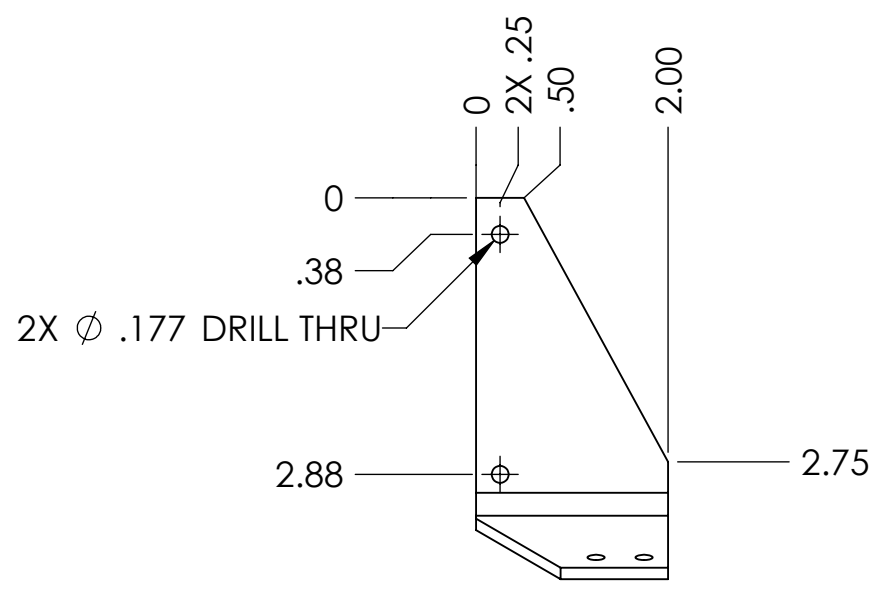
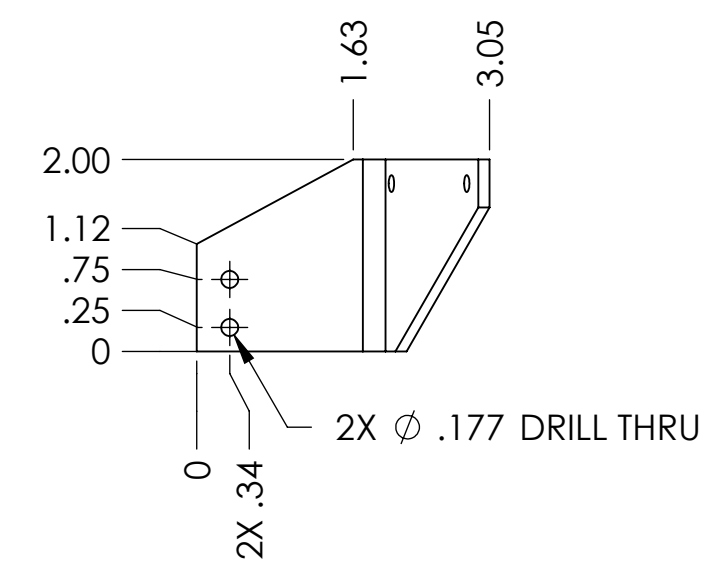
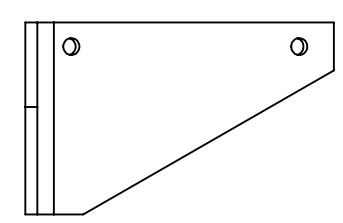
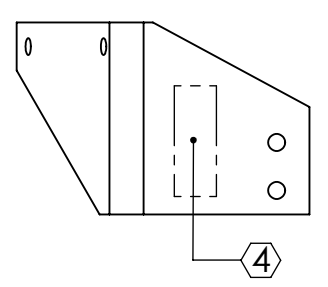

NOTES: (UNLESS OTHERWISE SPECIFIED)

- REMOVE ALL SHARP EDGES, R.02 MIN.
- DO NOT SCALE FROM DRAWING.
- ALL MACHINING FLUIDS SHALL BE WATER SOLUBLE AND FREE OF SULFUR, CHLORINE AND SILICONE, SUCH AS CINCINNATI MILACRON'S CIMTECH 410 (SSTL)
- SCRIBE, ENGRAVE, OR MECHANICALLY STAMP (NO INKS OR DYES) DRAWING PART NUMBER AND REVISION ON NOTED SURFACE FOLLOWED ON THE NEXT LINE BY A THREE DIGIT SERIAL NUMBER. SERIAL NUMBERS START AT 001 FOR THE FIRST ARTICLE AND PROCEED CONSECUTIVELY. USE .07" HIGH CHARACTERS. EXAMPLE: DXXXXXX-VY, S/N 001. A VIBRATORY TOOL MAY BE USED.

DIMENSIONS ARE IN INCHES

TOLERANCES:
 .XX ± .01
 .XXX ± .005

ANGULAR ± 0.5°

MATERIAL
6061-T6 Al

FINISH
32 μinch

	NAME	DATE
DESIGNER	D. BRIDGES	9 APR 2009
DRAWN	B. MOORE	16 APR 2009
CHECKED	D. BRIDGES	16 APR 2009

SYSTEM
ADVANCED LIGO

SUB-SYSTEM
SUS

NEXT ASSY
MOUNTING PAD ASSY

PART NAME
FRONT BRACKET, MOUNTING PAD

SIZE	DWG. NO.	REV.
B	D0900627	v1

SCALE: 1:1 PROJECTION: SHEET 1 OF 1

D0900627_Advanced_LIGO_SUS_HLTS_Mounting_Pad_Front_Bracket, PART PDM REV: X-005, DRAWING PDM REV: X-007