

- NOTES:
- REFER TO DOCUMENT D1101271 FOR OPTICAL TABLE HOLE TABULATION CONVENTION.
 - REFER TO G1000125 FOR ISI NAMING AND ORIENTATION CONVENTION.

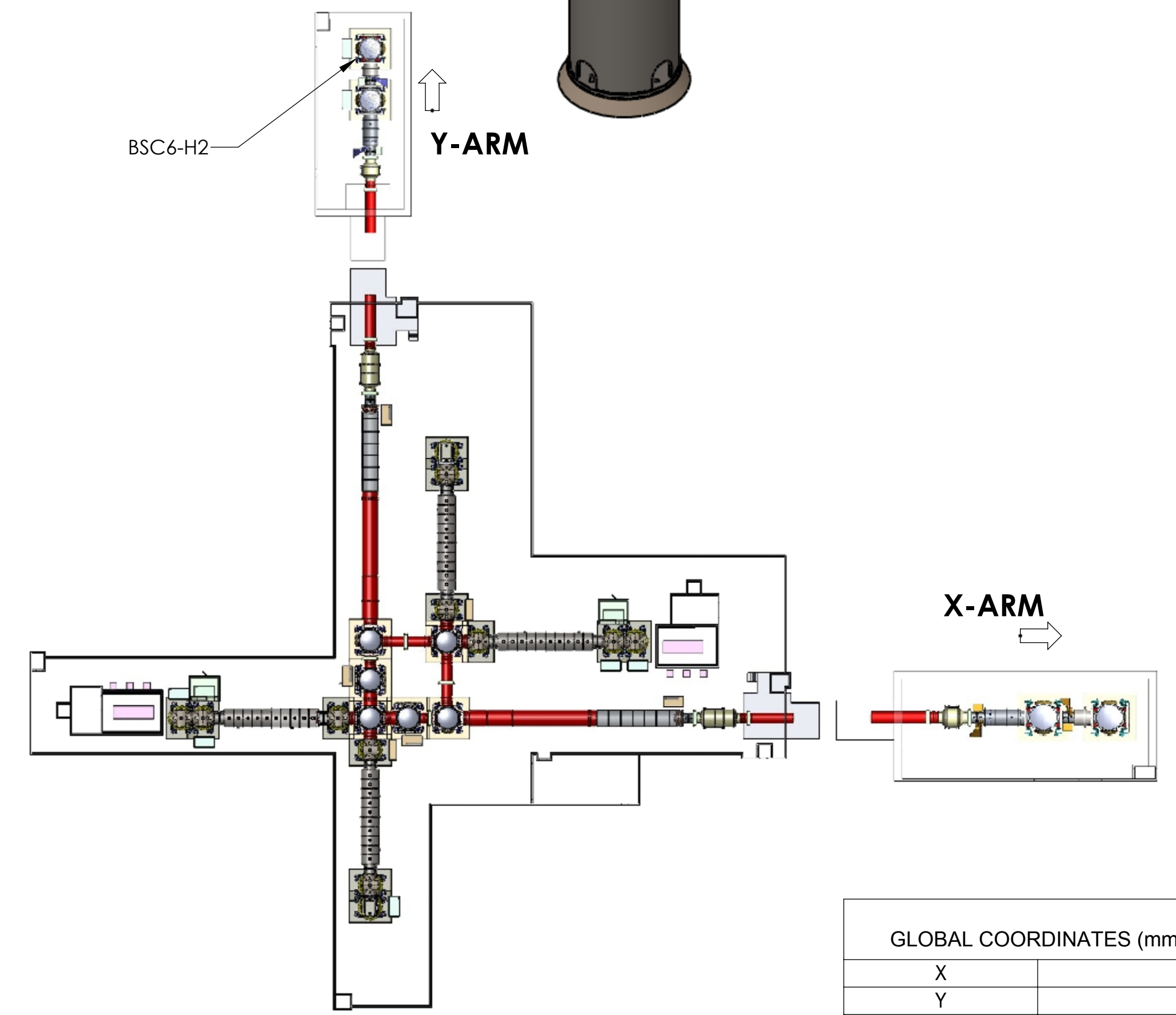
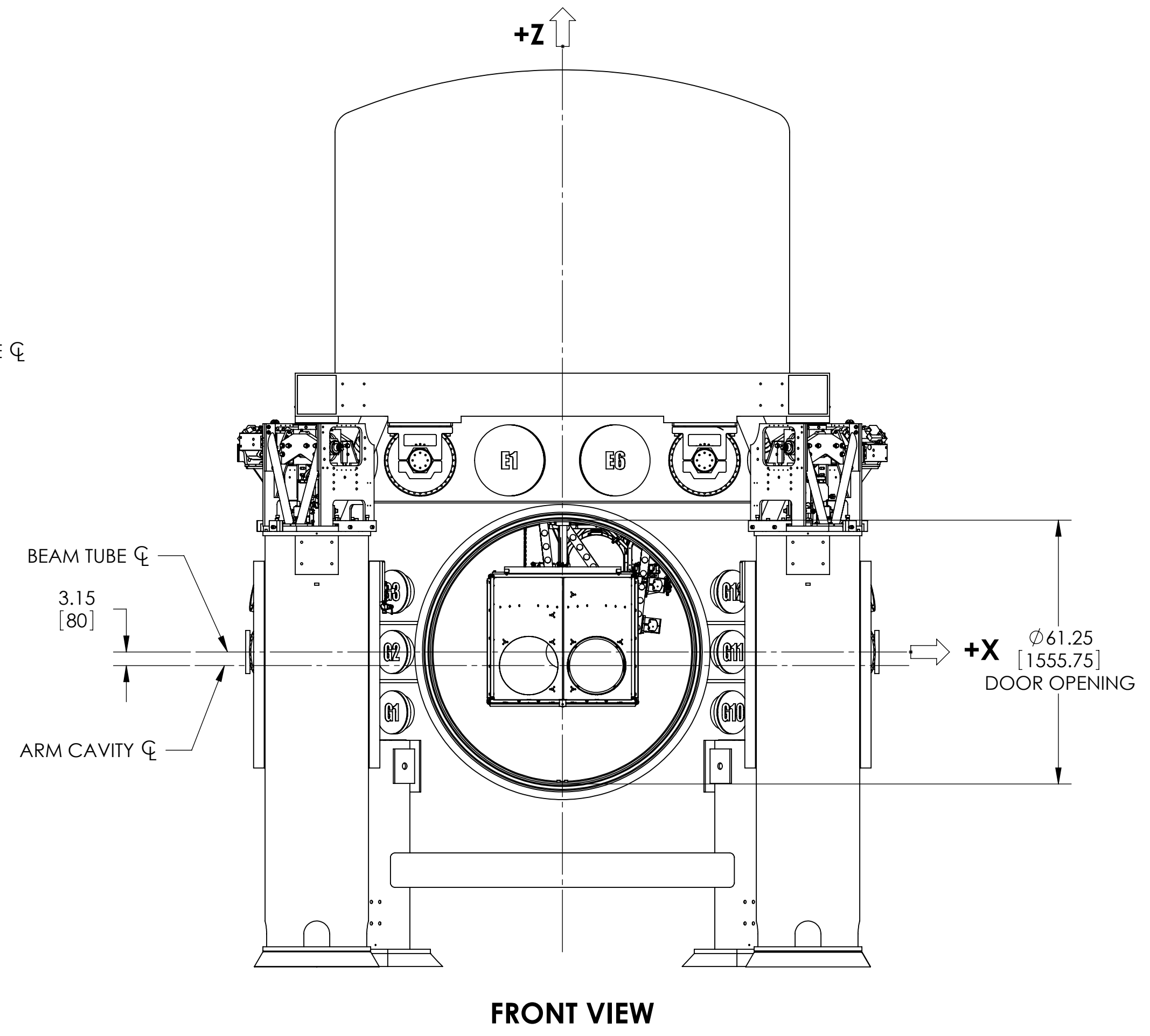
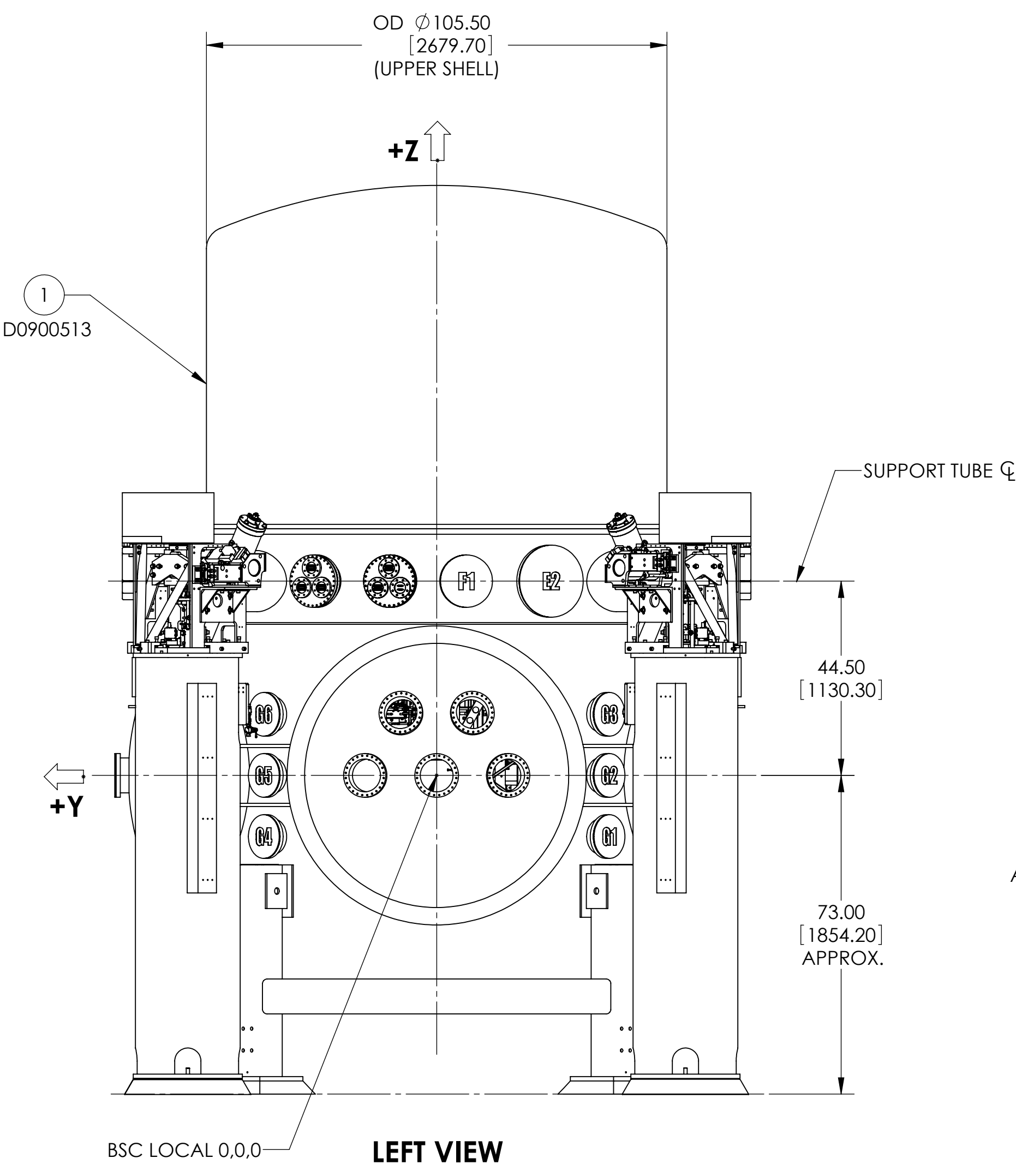
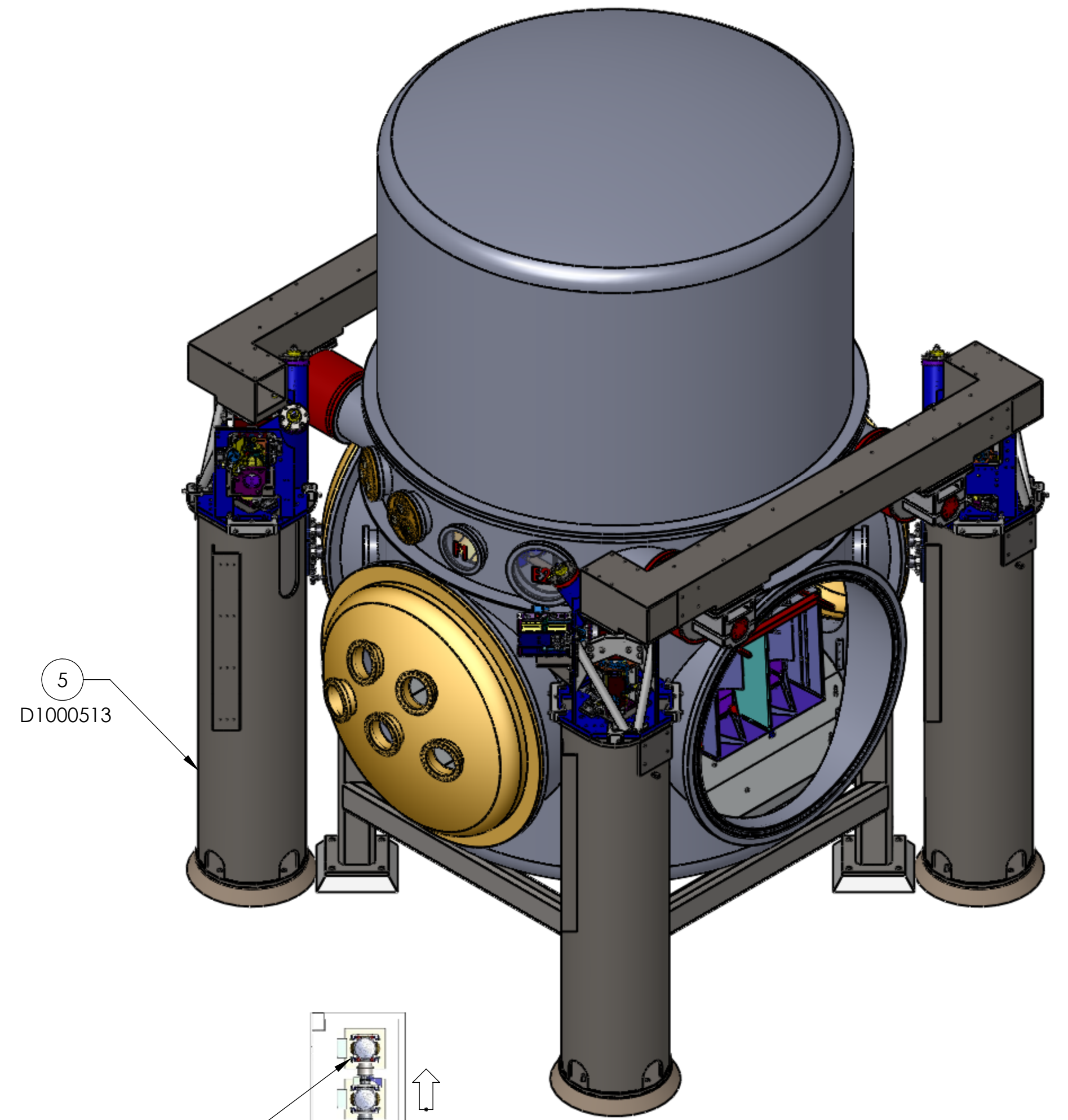
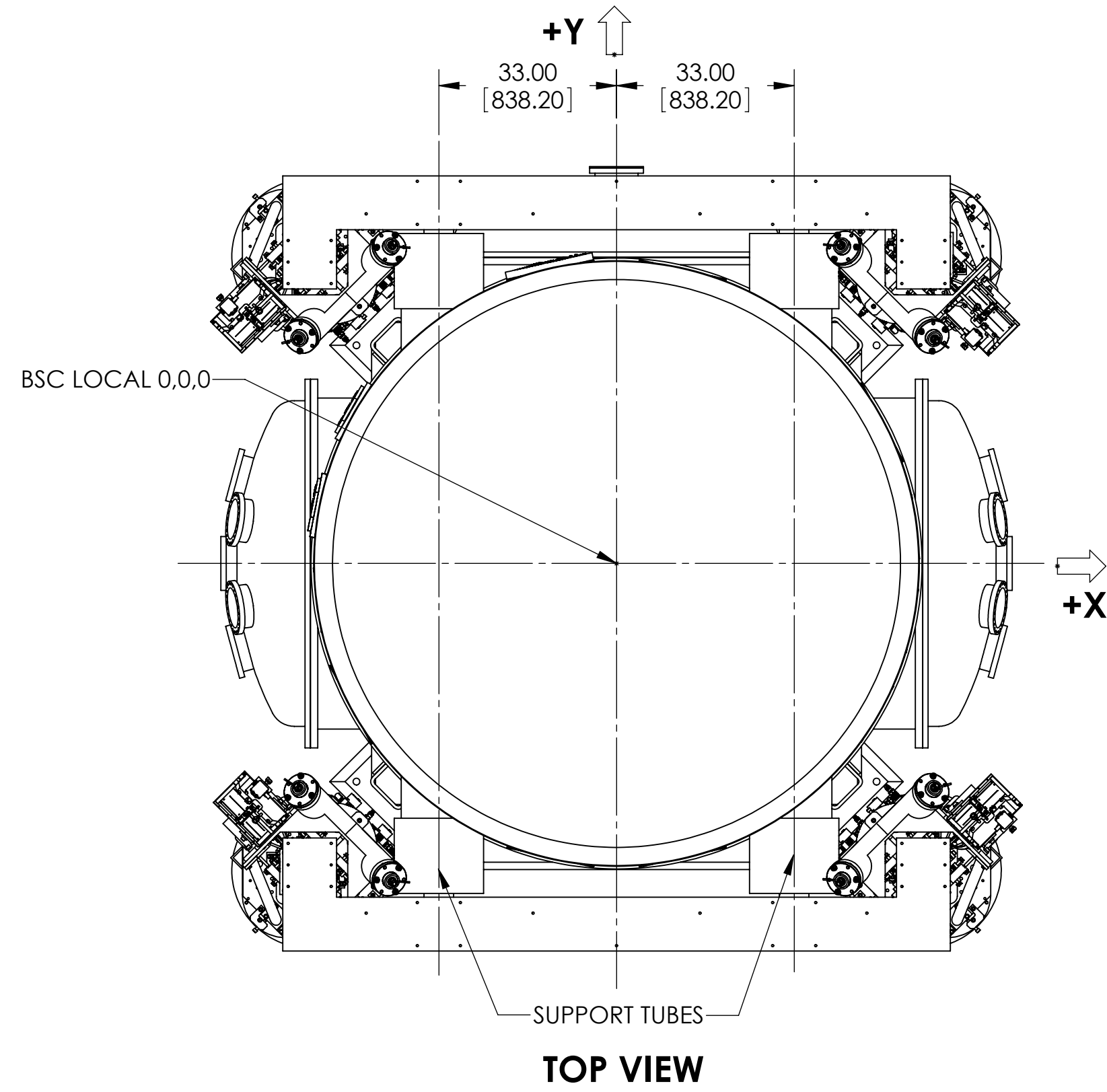

GLOBAL COORDINATES (mm)	
X	
Y	
Z	

DIMENSIONS ARE IN INCHES [MM]		NOTES AND TOLERANCES: (UNLESS OTHERWISE SPECIFIED)	
TOLERANCES: .XX ± .XXX ±		1. INTERPRET DRAWING PER ASME Y14.5-1994. 2. REMOVE ALL SHARP EDGES, .005-.015, FOR MACHINED PARTS. ROUND ALL EDGES APPROXIMATELY R.02 FOR SHEET METAL PARTS. 3. DO NOT SCALE FROM DRAWING. 4. ALL MACHINING FLUIDS MUST BE FULLY SYNTHETIC, FULLY WATER SOLUBLE AND FREE OF SULFUR, SILICONE, AND CHLORINE.	
ANGULAR ± °		MATERIAL	FINISH
		--	-- μinch

CALIFORNIA INSTITUTE OF TECHNOLOGY MASSACHUSETTS INSTITUTE OF TECHNOLOGY		PART NAME	
SYSTEM	ADVANCED LIGO	SUB-SYSTEM	SUS
NEXT ASSY		BSC6-H2 TOP LEVEL CHAMBER ASSEMBLY, FULLY DEFINED	

DESIGNER	ED CHAVEZ	25 SEP 2011	SIZE	DWG. NO.	REV.
DRAFTER	C. TORRIE	03 OCT 2011	D	D0900512	v8
CHECKER	SEE DCC		SCALE: 1:24	PROJECTION:	SHEET 1 OF 3
APPROVAL					

D0900512_A041LIGO Systems: BSC6-H2 Top Level Chamber Assembly, All Part PDM REV: X-096, DRAWING PDM REV: X-008

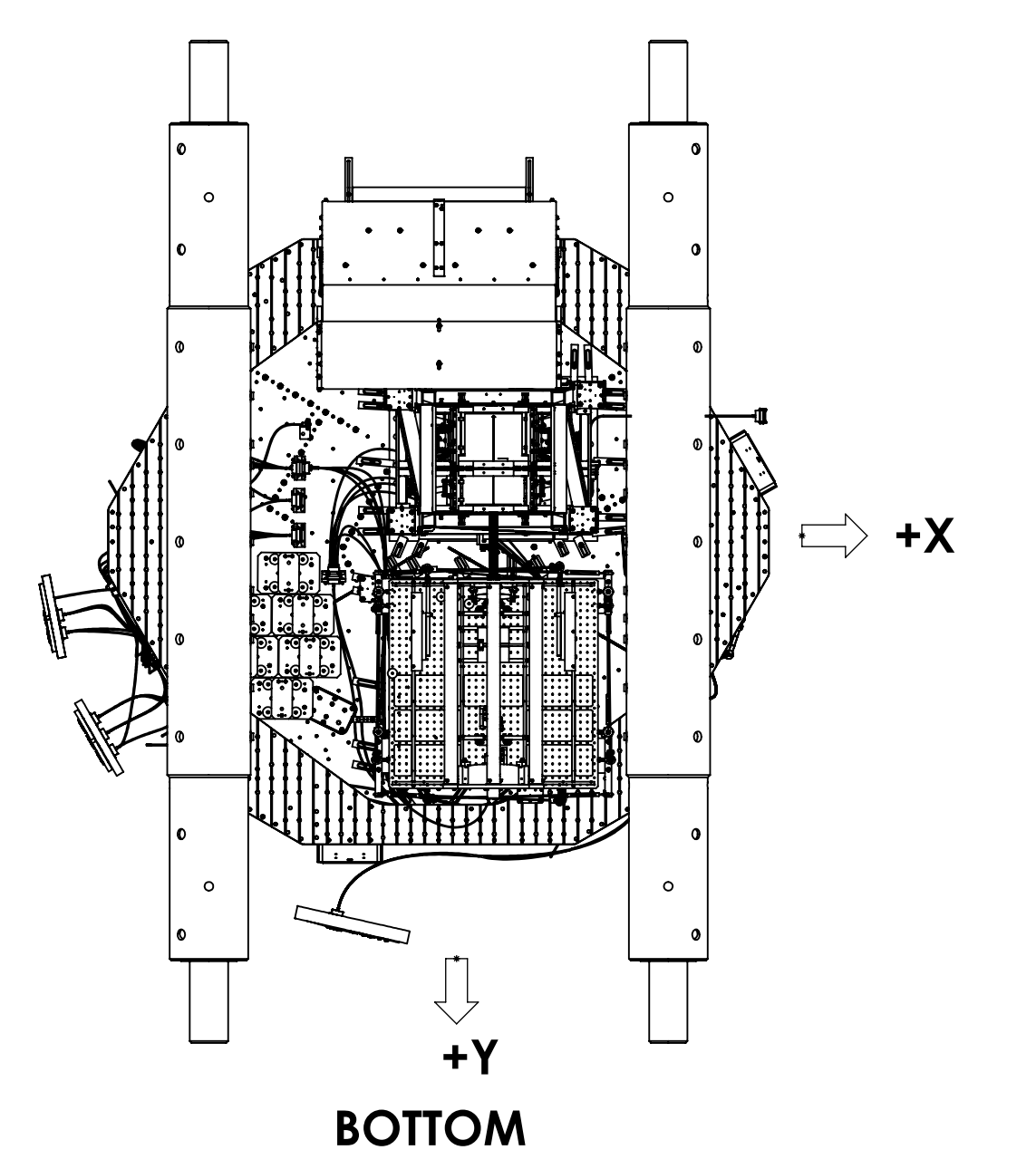
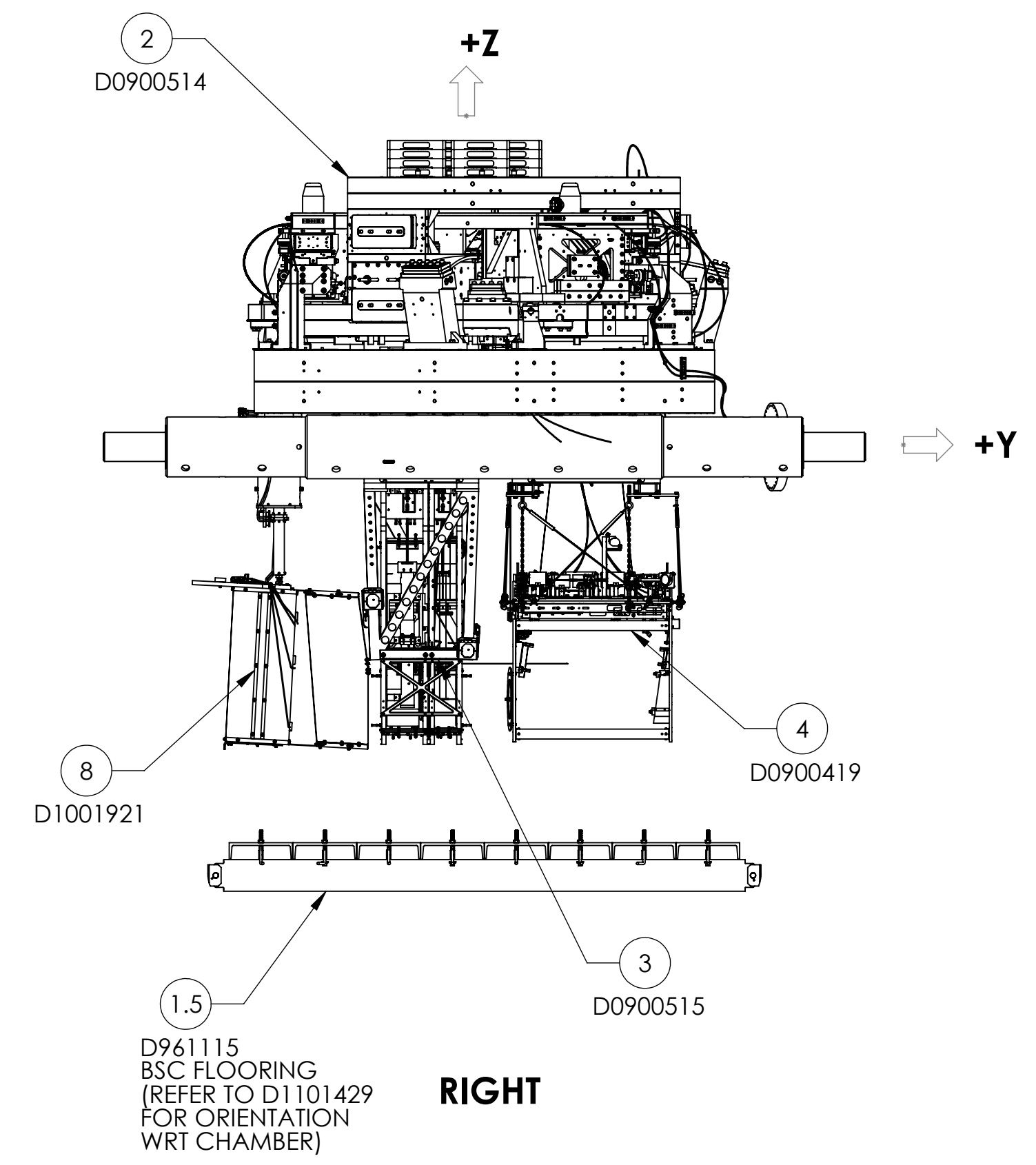
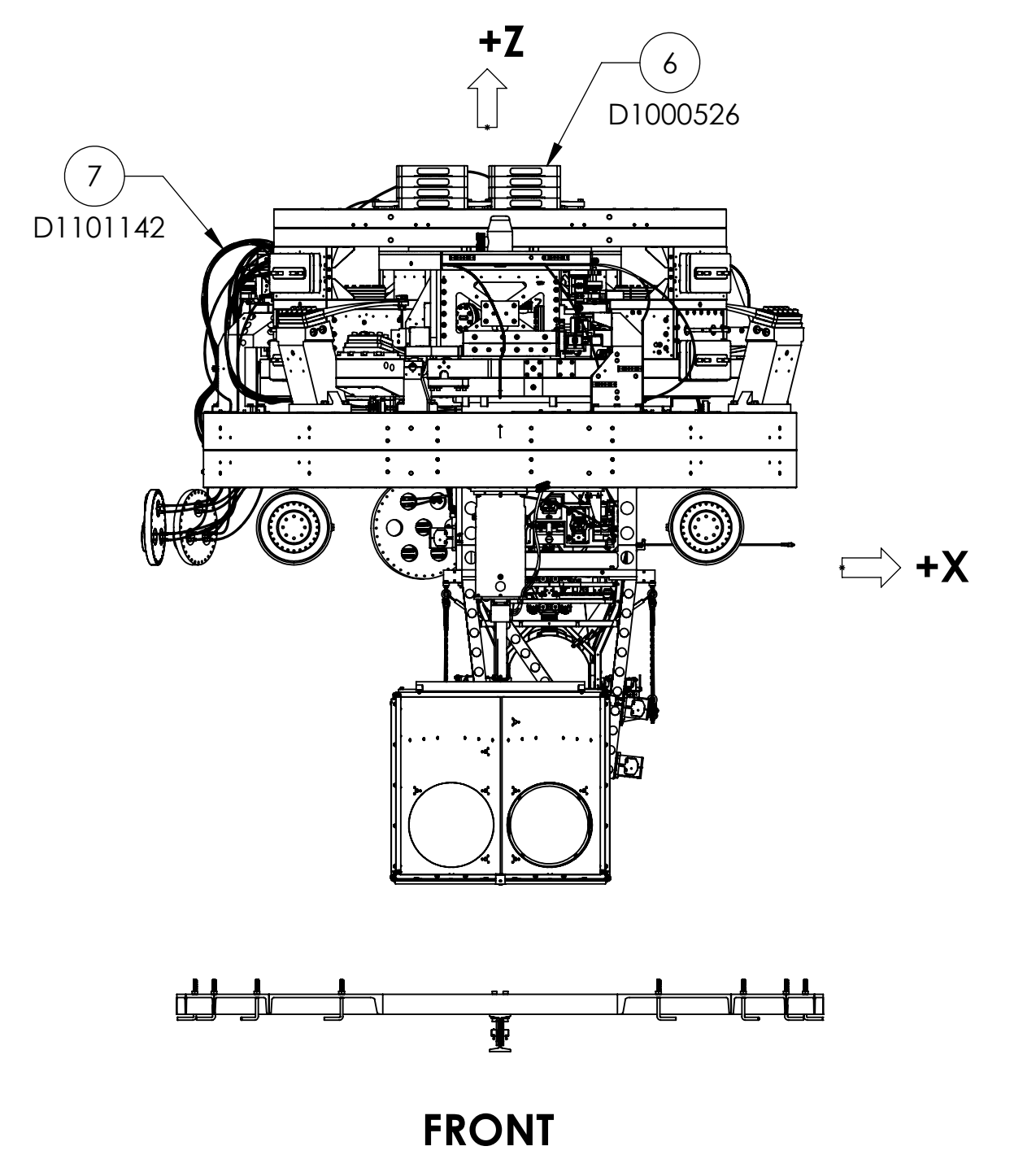
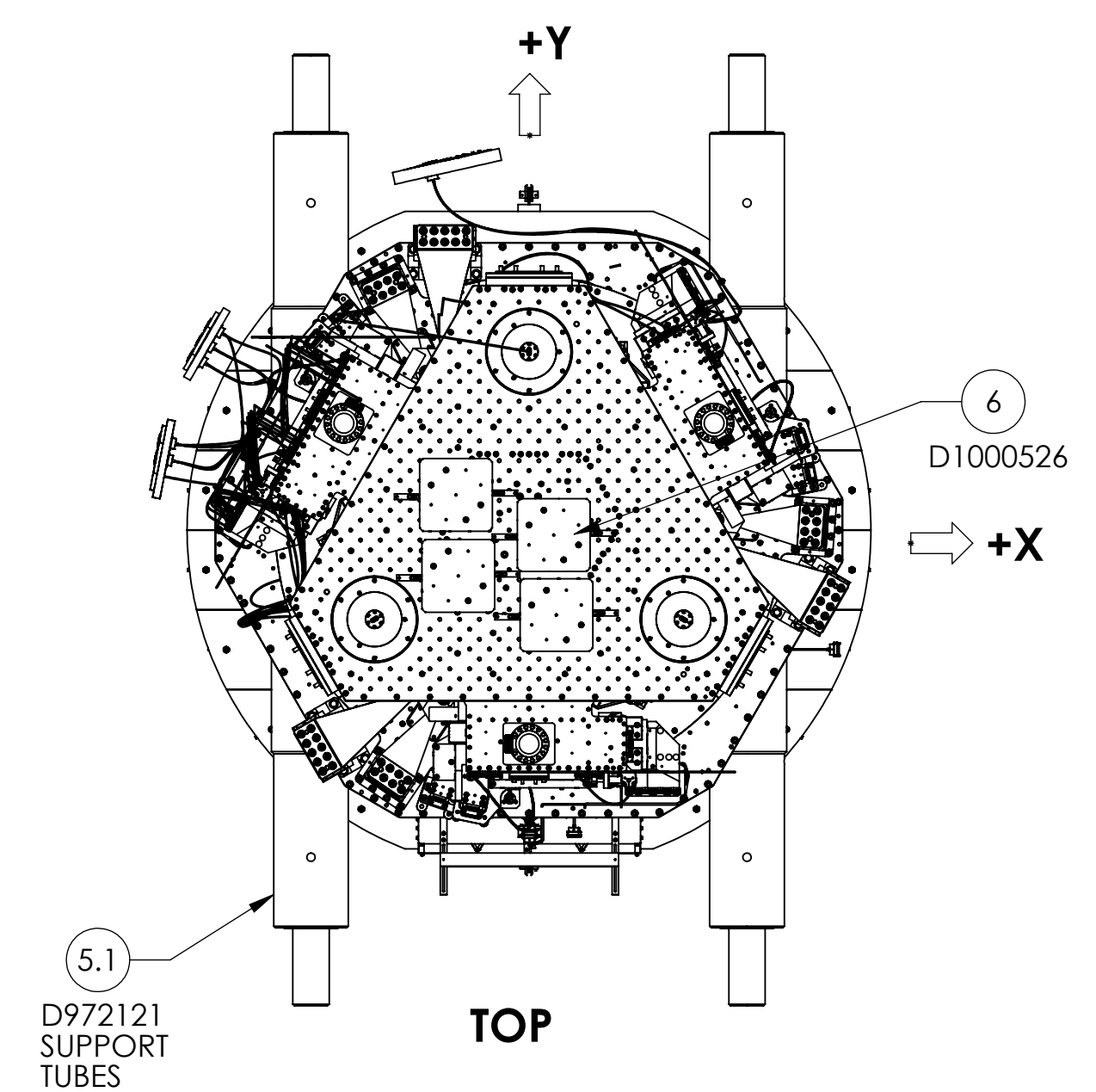
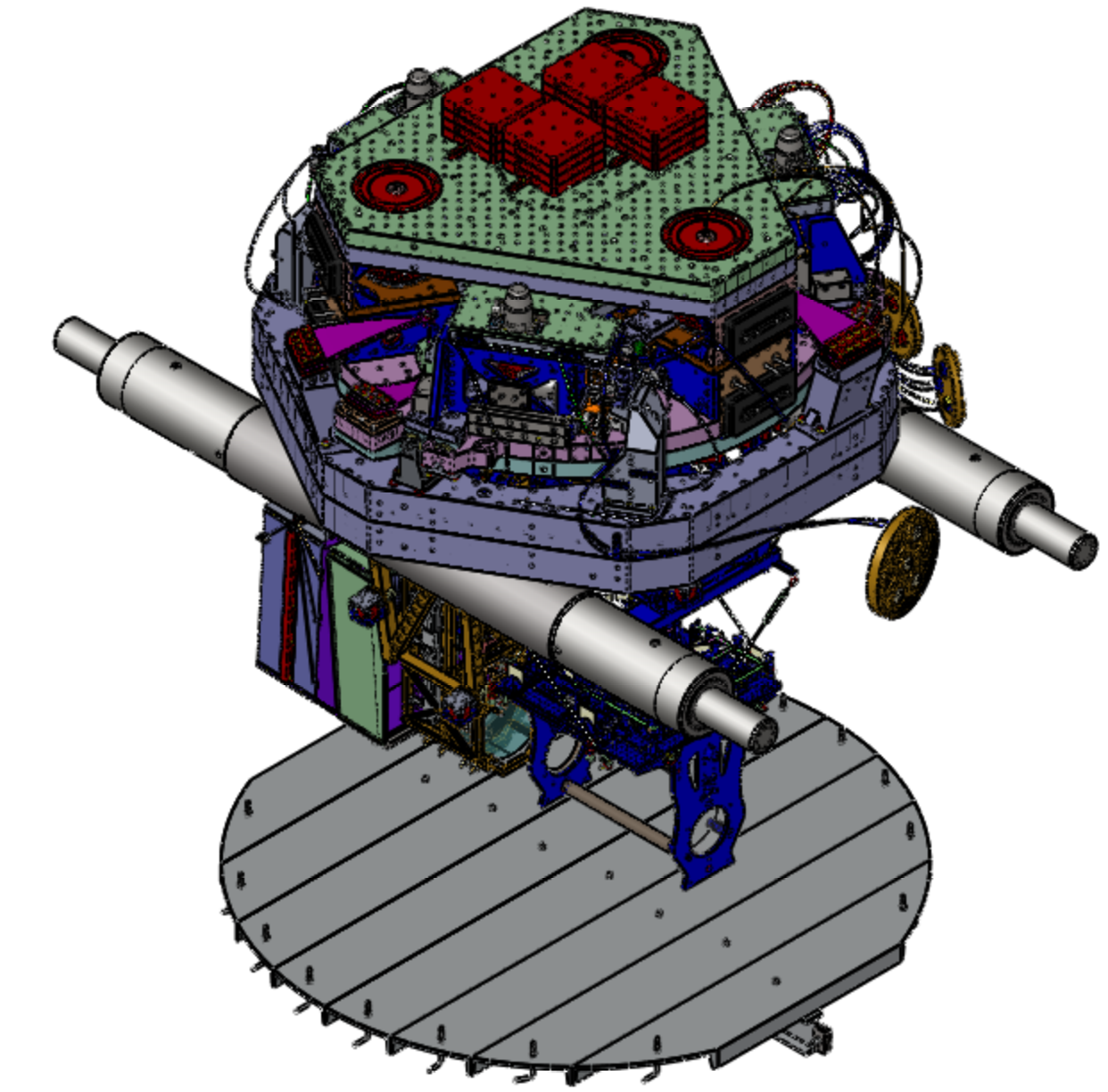

ITEM NO.	QTY.	PART NUMBER	DESCRIPTION
8	1	D1001921	AdvLIGO BSC6-H2, XYZ Local CS for SLC Arm Cavity Baffle
7	1	D1101142	ALIGO, CABLE HARNESS ROUTING, BSC-6 H2
6	1	D1000897	AdvLIGO BSC6-H2 ISI Table, Payload & Suspended Masses Assy
5	1	D1000513	HEPI ASSEMBLY, BSC aLIGO
4	1	D0900419	AdvLIGO SUS BSC6-H2, XYZ Local CSm for ETM Tel Assy
3	1	D0900515	AdvLIGO SUS BSC6-H2, XYZ Local CS for ETMY
2	1	D0900514	AdvLIGO SEI BSC6-H2, XYZ Local CS for ISI Table
1	1	D0900513	AdvLIGO Systems BSC6-H2, Vacuum Equipment Assembly

LIGO CALIFORNIA INSTITUTE OF TECHNOLOGY
MASSACHUSETTS INSTITUTE OF TECHNOLOGY

SIZE DWG. NO. **D0900512** REV. **v8**

SCALE: 1:25 PROJECTION: SHEET 2 OF 3

D0900512 AdvLIGO Systems BSC6-H2 Top Level Chamber Assembly, All Part PDM REV-X-096, DRAWING PDM REV-X-008

8 7 6 5 4 3 2 1

H G F E D C B A

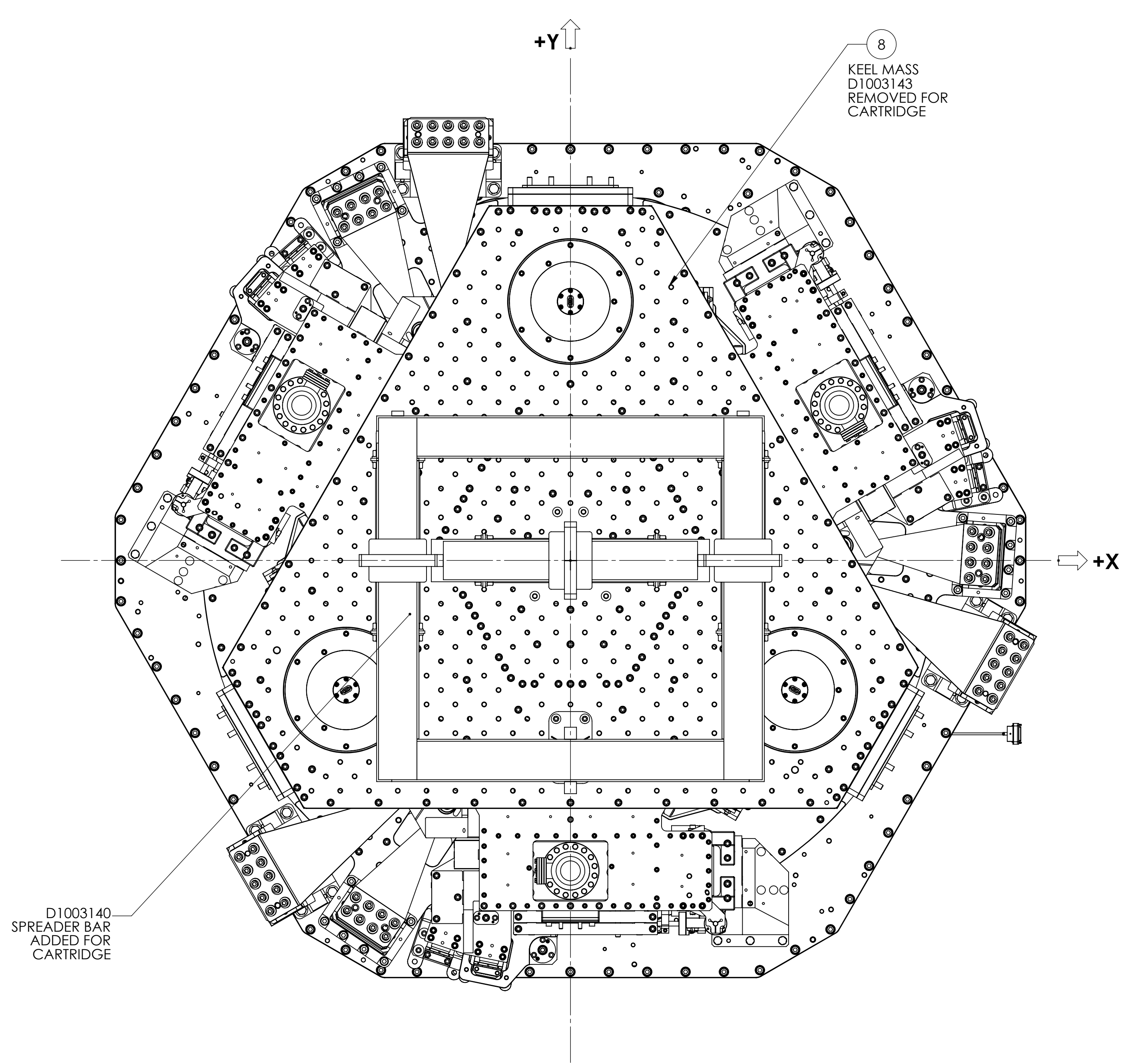

**TOP VIEW
(LOOKING DOWN)
CARTRIDGE ASSEMBLY
CONFIGURATION
(KEEL MASS REMOVED)**

CLUSTER POSITIONS

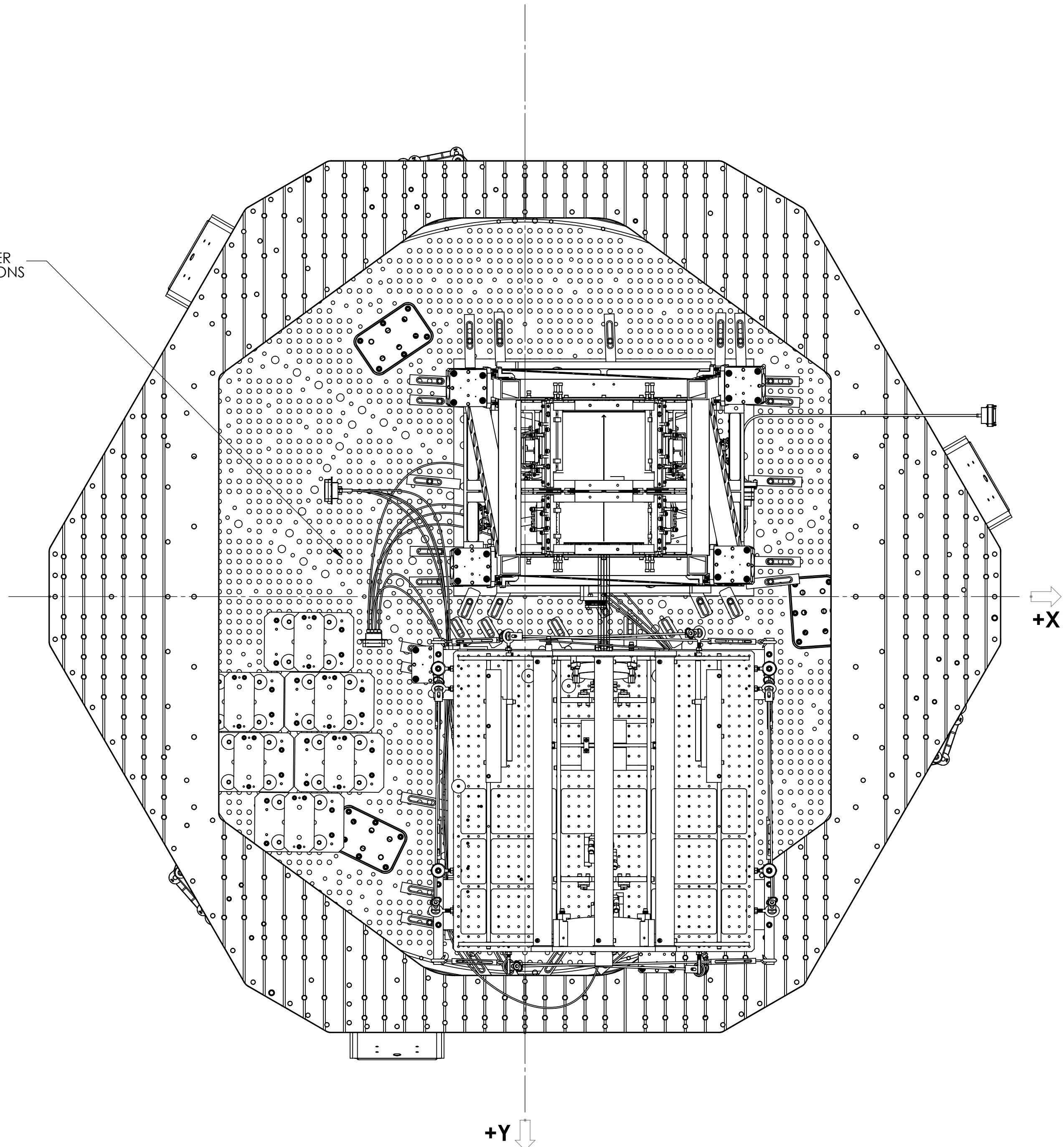

**BOTTOM VIEW
(LOOKING UP)**

D0900512_A04/LIGO Systems: BSC-412 Top Level Chamber Assembly, All Part FDM REV-X-096, DRAWING FDM REV-X-009

CALIFORNIA INSTITUTE OF TECHNOLOGY MASSACHUSETTS INSTITUTE OF TECHNOLOGY	
SIZE DWG. NO.	REV.
D D0900512	v8
SCALE: 1:8	PROJECTION:
SHEET 3 OF 3	

8 7 6 5 4 3 2 1