

D071427_Asm-Outer_Wall-Small_Panel, PART PDM REV: V1-006, DRAWING PDM REV: X-000

NOTES CONTINUED:
 5. Refer to LIGO-E0900216 for detailed assembly instructions.
 6. Weight of finished assembly: 17 lbs

REV.	DATE	DCN #	DRAWING TREE #
v1 / C	08 JAN 2008	N/A	N/A
v2	11 JAN 2010	E1000001	T0900305
-	-	-	-

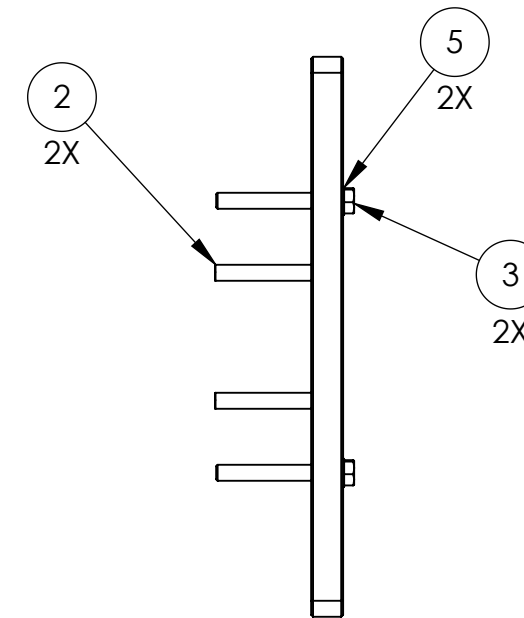
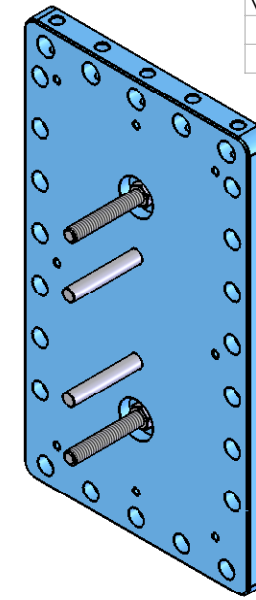
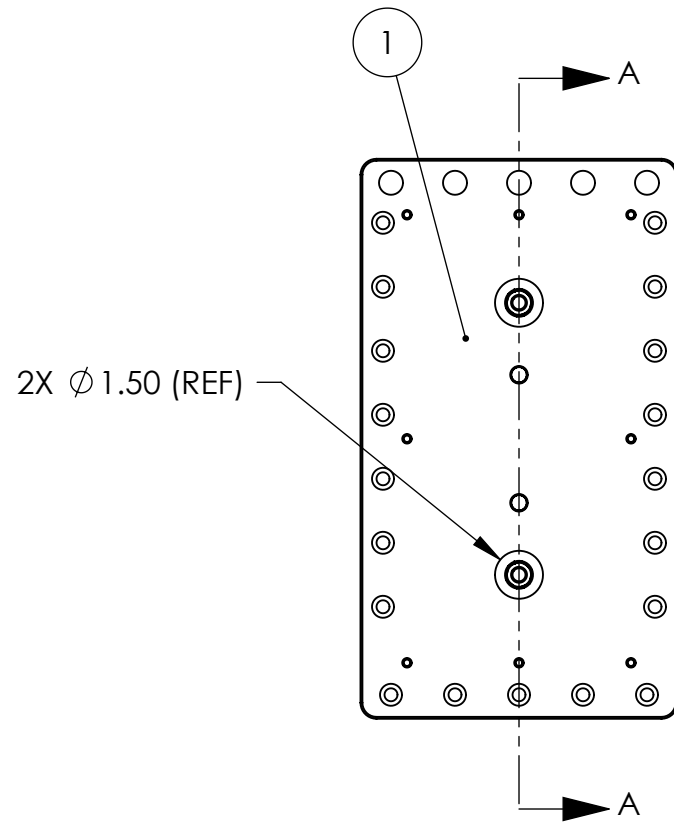
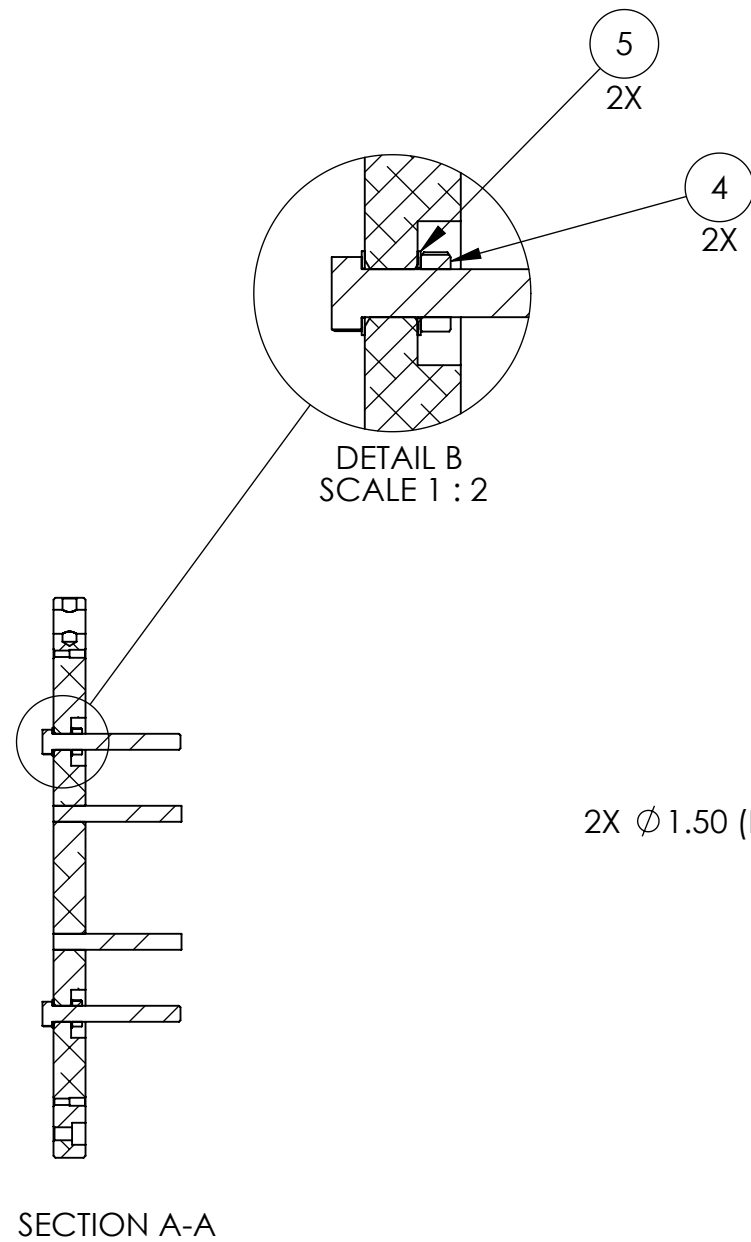

ITEM NO.	PART NUMBER	DESCRIPTION	SIZE / TYPE	MATERIAL	Default/QTY.
5	UCC_WFV-50	Vented Washer, 1/2"	1/2" (.52"x.88")	18-8 SS	4
4	D0900204	Hex Nut, Custom Ag-Plated, 1/2"-13	1/2"-13, Ag-Plated	18-8 SS	2
3	MCMASTER_92240A728	HHCS, 1/2"-13x4.0"	1/2"-13x4.0", Full Thread	18-8 SS	2
2	MCMASTER_90145A729	Dowel Pin, 1/2"x4.0"	1/2"x4.0"	18-8 SS	2
1	D071059	Outer Wall, Small Panel	-	6061-T6 Al	1

PARTS LIST

NOTES AND TOLERANCES: (UNLESS OTHERWISE SPECIFIED)

1. INTERPRET DRAWING PER ASME Y14.5-1994.
 2. REMOVE ALL SHARP EDGES, R.02 MIN.
 3. DO NOT SCALE FROM DRAWING.
 4. ALL MACHINING FLUIDS MUST BE FULLY SYNTHETIC, FULLY WATER SOLUBLE AND FREE OF SULFUR, SILICONE, AND CHLORINE.

DIMENSIONS ARE IN INCHES

TOLERANCES:
 .XX ± .015
 .XXX ± .005

ANGULAR ± 0.5°

MATERIAL See BOM

FINISH See BOM

LIGO CALIFORNIA INSTITUTE OF TECHNOLOGY
 MASSACHUSETTS INSTITUTE OF TECHNOLOGY

SYSTEM: ADVANCED LIGO SUB-SYSTEM: SEI

PART NAME: Asm, Outer Wall, Small Panel

DESIGNER: Andy Stein 17 FEB 2009 SIZE DWG. NO. REV.
 DRAFTER: Andy Stein 11 JAN 2010 **B** D071427 v2

CHECKER: Ken Mason 11 JAN 2010 SCALE: 1:6 PROJECTION: SHEET 1 OF 1

APPROVAL: NEXT ASSY: D0900124