

REVISION HISTORY				
REV	DATE	ECO	APPROVAL	DESCRIPTION
V1 / C	12 Jun 2007	1064	D. Senders	Release for Enhanced LIGO.
V2	25 Mar 2009		A. Stein	Release for Advanced LIGO. Changed 1/4"-20 holes from Heli-Coil to regular tap. Added c'sinks.

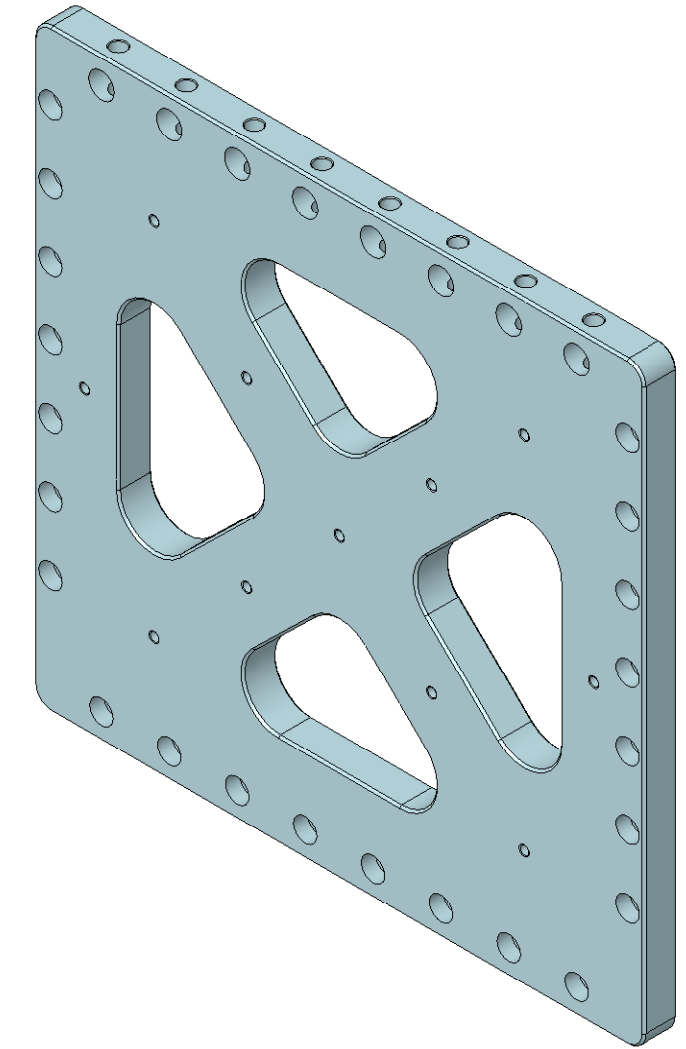
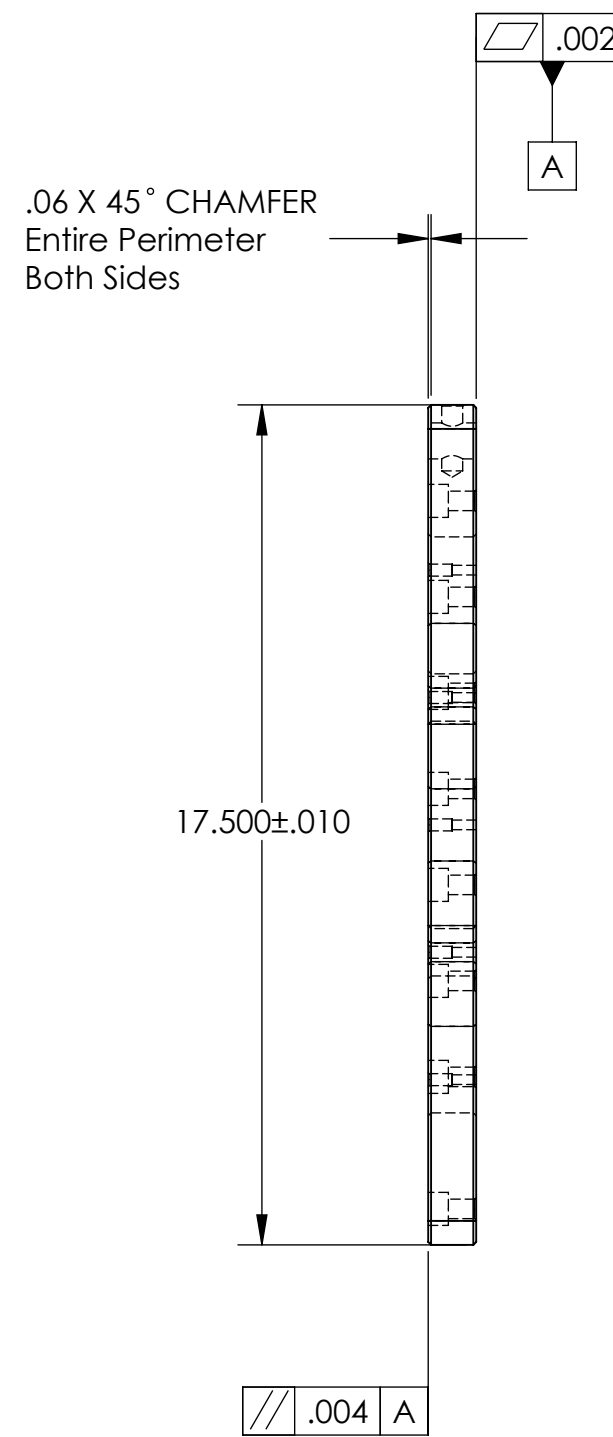
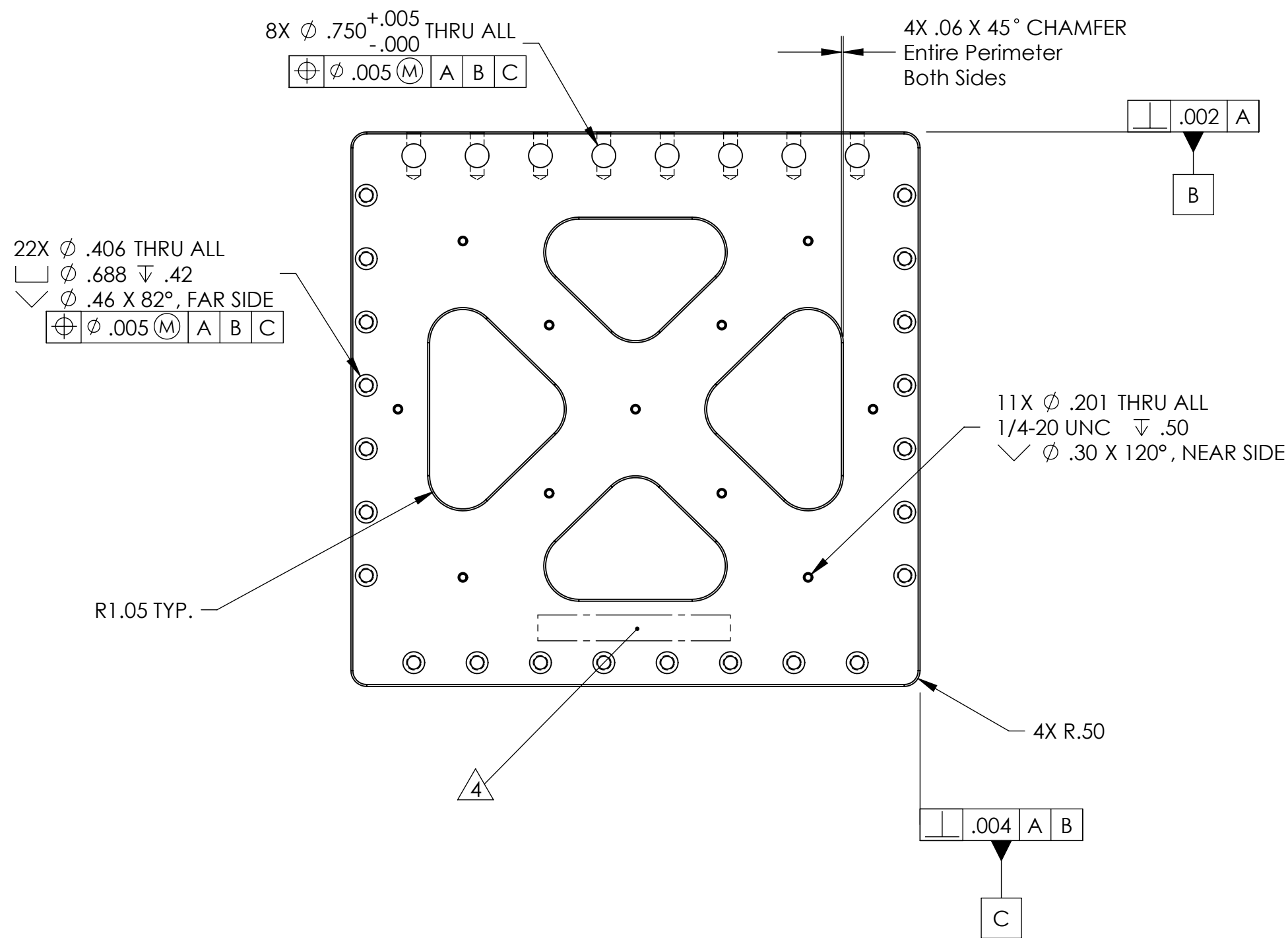
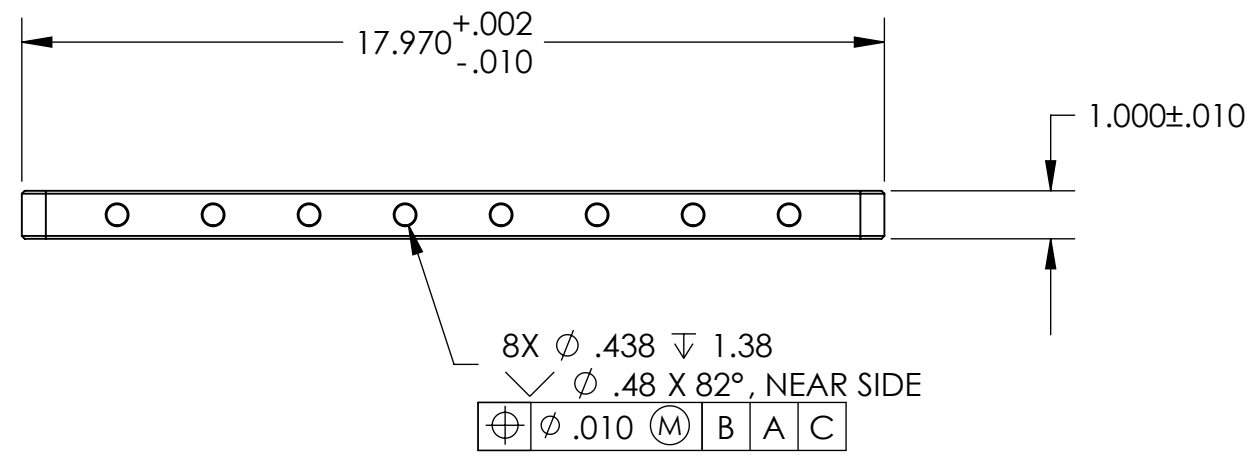

MACHINING NOTES:

- 1) MACHINE ALL SURFACES TO REMOVE OXIDES AND MILL FINISH. ABRASIVE REMOVAL TECHNIQUES (OTHER THAN DRESSED BLANCHARD GRINDING) ARE NOT ACCEPTABLE.
- 2) ALL MACHINING FLUIDS MUST BE WATER SOLUBLE AND FREE OF SULFUR, CHLORINE, AND SILICONE, SUCH AS CINCINNATI MILACRON CIMTECH 410.
- 3) THOROUGHLY CLEAN PART TO REMOVE ALL OIL, GREASE, DIRT, AND CHIPS.
- 4) WHERE INDICATED, MECHANICALLY SCRIBE, STAMP, OR ENGRAVE THE FOLLOWING INFORMATION AS SHOWN BELOW: **PART NUMBER-REVISION** (AND **TYPE** IF INDICATED), FOLLOWED ON THE NEXT LINE WITH A UNIQUE 3-DIGIT **SERIAL NUMBER** STARTING AT 001 FOR THE FIRST PART AND INCREMENTING THEREAFTER. USE 0.38" TALL CHARACTERS UNLESS PART SIZE DICTATES SMALLER.

D071058-V2
S/N - ###

POST-MACHINING NOTES:

- P1) CLEAN TO LIGO STANDARDS, CLASS A.

UNLESS OTHERWISE SPECIFIED: DIMENSIONS ARE IN INCHES DECIMAL TOLERANCES: .XX ±.015 .XXX ±.005 ANG TOL: ± 1° SURFACE ROUGHNESS: 6.3 REMOVE ALL SHARP EDGES. LEAVE .005 X 45° MIN CHAMFER, OR .005 MIN RADIUS.		ORIGINAL DESIGN BY: High Precision Devices 1448 Valtec Lane, Suite C, Boulder, Colorado 80301 Phone: (303) 447-2558 Fax: (303) 447-2548 Web Site: www.hpd-online.com	MODIFIED BY:
APPROVALS: ENGINEERING (HPD): D. Senders 5/29/2007 QUALITY (HPD): C. Danaher 5/29/2007 MATERIAL: 6061-T6 Al FINISH: None MASS: 23.0 lbs	DESCRIPTION: Outer Wall, Flexure Access P/N: D071058 CONFIG: - CAD FILE NAME: D071058_Outer_Wall-Flexure_Access PROJECT: HAM ISI, Advanced LIGO	SIZE SCALE: 1:4 DRAWN BY: Dave Senders (HPD) REV V2 SHEET 1 OF 1 DATE PRINTED: 3/25/2009	